

GREEN MOWER

LM55GD · LM55GDF

LM65GD · LM65GDF

TEERING GROUND MOWER

LM65TD · LM65TDS

BARONNESS

LAWN MOWER

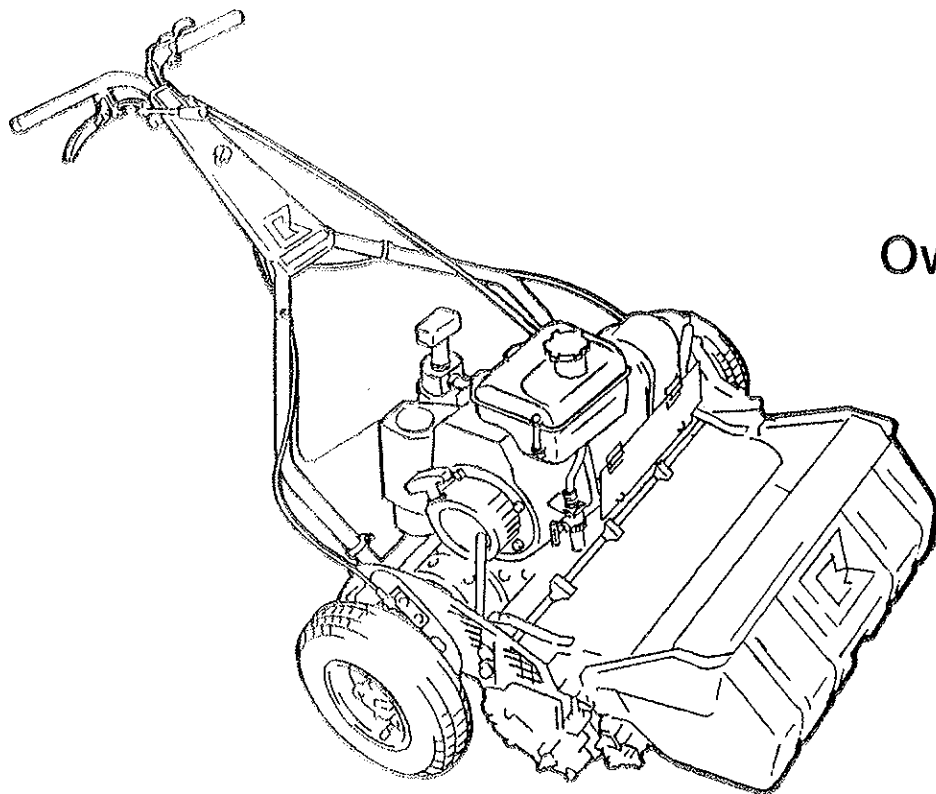

Owner's Handling Manual & Parts Catalog

2000

Read this manual before using the machine.

BARONNESS

CONTENTS

CONTENTS	1
Warning for Safety	2
Greeting	2
Owner's Handling Manual	2
1. Part names	3
2. Specifications	4
3. Features	4
4. Assembly/adjustment of main unit	5
5. Inspection before use	6
6. Fastening of each portion	6
7. Engine starting sequence	6
8. Machine operation	6 • 7 • 8 • 9
9. Blade engagement	9 • 10 • 11
10. Long-term storage	11
11. Precautions for engine operation	12
12. Special optional parts	12 • 13

Parts Catalog	14
1. Blade reel cylinder / bottom blade	15 • 16 • 17 • 18
2. Drum wheel	19 • 20
3. Engine clutch portion	21 • 22
4. Frame/transmission	23 • 24 • 25 • 26
5. Handle/engine	27 • 28
6. Brake parts	29 • 30
7. Grass catcher / tools	31 • 32
8. Sulky unit option	33 • 34
9. Groomer	35 • 36 • 37 • 38
9. Tee groomer	39 • 40 • 41 • 42
10. Sweeper brush option	43 • 44
11. Vertical blade option	45 • 46

Warning for Safety

Warning marks indicate important items for safety.
Observe them strictly.

Warning Marks



Negligence of the warning will cause death or serious injury.

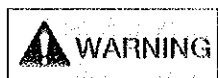

Negligence of the warning may cause death or serious injury.



Negligence of the warning may cause injury.

Symbols



See the Handling Manual



Engine switch lever



Fuel: Gasoline



Hot surface
Burn on hand



Danger mark
Hand cut



Danger mark
Foot cut



Grease
Every 10 hours



CAUTION: Joint shaft

Greeting

Thank you very much for purchasing BARONESS GREEN MOWER and TEEING GROUND MOWER.

This Owner's Handling Manual explains the method of correct handling, adjustment, and maintenance of the mower. Thoroughly read the manual before operation. Carefully read the engine operation manual before starting the engine. Mowers undergo thoroughgoing trial operation and inspection before shipment. However, whether or not the mower can exhibit the expected performance depends on the handling method, inspection/adjustment before and after operation, and the properness of lubrication. Handle the mower correctly for safe and excellent operation for an extended period of time.

Owner's Handling Manual

Precautions:

- The name of the model may be different when you make an inquiry about your machine. Advise us of the machine number as well.
- The contents of this manual are subject to change without notice.



CAUTION

The warning marks attached to the machine indicate precautions for safety. Read them carefully. Understand well the operating procedures and safety precautions before using the machine. The marks and explanatory notes should be kept clean. If they are lost or damaged, attach new marks.

1. Part names

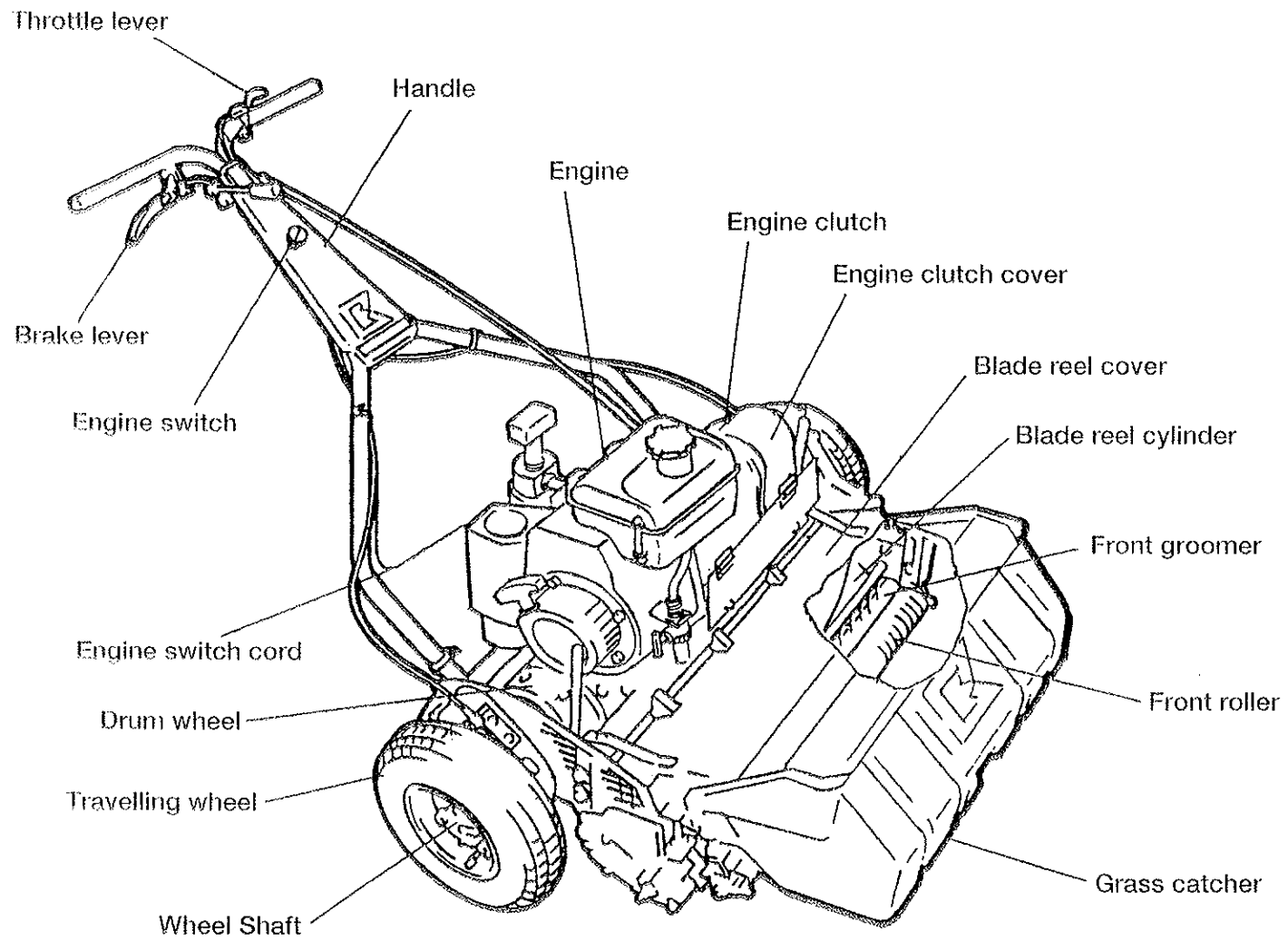

2. Specifications

2-1. Main unit

	LM55GD(GDF)	LM65GD(GDF)	LM65TD(TDS)
Length (cm)	154.5	←	←
Width (cm)	93.2	102.2	102.2
Height (cm)	96.5	←	←
[Weight] During operation (kg)	84.8 (89)	89.5 (93.5)	89.5 (93.5)
[Weight] Grass catcher	3.6	4.1	4.1
[Mowing section] Mowing width (cm)	55.6	64.6	64.6
[Mowing section] Reel dia. (cm)	φ 12.8	←	←
[Mowing section] Number of reel blades (cm)	9	←	7
Frame	Aluminum alloy	←	←
Front roller (cm)	φ 6×57.7	φ 6×66.6	φ 6×66.6
Drum wheel (cm)	φ 19.6×53.5	φ 19.6×62.5	φ 20.3×62.5
Speed (km/h)	4.8	←	←
Engine EY15D	K2620000130	←	←

- Weight does not include the transport wheels (6.6 kg) and grass catcher.
- Speed is indicated at an engine speed of 3000 rpm.

	Front groomer		Dethatching reel		Dethatching brush	
	Working width (cm)	Number of blades (cm)	Working width (cm)	Number of blades (cm)	Working width (cm)	Dia (cm)
LM55 Series	510	80	510	40	490	φ 60
LM65 Series	589	92	589	46	575	φ 60

Dethatching blade thickness is 0.5mm, Dethatching blade diameter is 63mm.

3. Features

- 3-1.** These models are suitable for mountain golf courses because engine brake is automatically activated.
- 3-2.** Ball bearings incorporated in the drum have increased the durability.
- 3-3.** The preload applied to the taper bearing of the blade reel cylinder is maintained at the same level by a coil spring for facilitating adjustment.
- 3-4.** Front groomer
Mowing is possible simultaneously.
- (1) G groomer (Reference: Parts catalog p.35)
The front groomer is positioned near the grooved roller to prevent adhesion of grass. Normal rotation improves the conventional dethatching performance. This is provided for LM55GDF and 65GDF as standard equipment.
- (2) T groomer (Reference: Parts catalog p.39)
The number of blades for deep grooming is half in comparison with the G groomer. This is provided for 65TDS as standard equipment.
- (3) Dethatching brush (Reference: Parts catalog p.39)
This is a spiral rotary brush between the grooved roller and blade reel cylinder. This is used for dethatching and having grass stand straight.

4. Assembly/adjustment of main unit

4-1. Fit the handles into the handle pins on both sides of the frame, respectively, in order of (a), (b), and (c).

- Fit the handle mounting pin R (4-61) on the left frame (4-1) into the hole at the front end of the handle. ←
- Pull the right edge of the handle toward the inside. ←←
- Fit the handle pin L (4-85) on the right frame into the hole at the right front end of the handle. →→

※ Adjust the clutch rod according to the height of the handle.

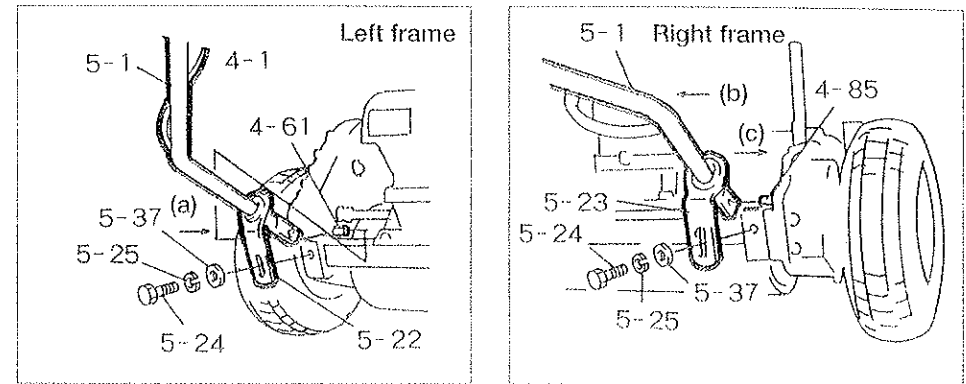

4-2. Installation of stand

Hook the U-shaped portion of the spring on the pin using a tool to install the stand.

4-3. Installation and adjustment of clutch rod

Install the clutch rod with a snap pin. Make adjustment according to the height of the handle until the clutch operates perfectly.

4-4. Connection of engine switch cord

Connect the engine switch cord during installation of the handle. Connect two positions - the plug and the terminal.

- Connect the plug with the plug connected to the front of the engine.
- Loosen the bolt on the left side of the engine, insert the terminal, and tighten the bolt. (P.28 5-28 8bolt 15S) Be sure to connect the engine switch cord, otherwise the engine will not stop.

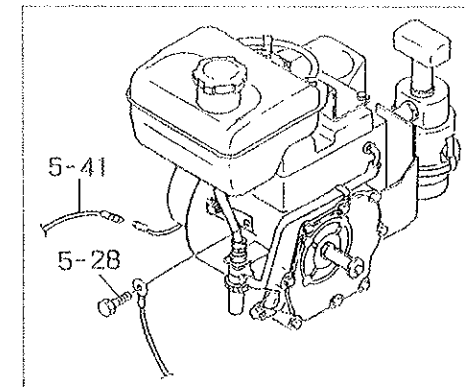
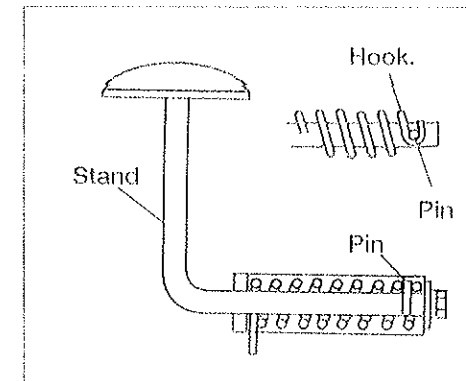

5. Inspection before use

5-1. Greasing



The transmission and intermediate transmission gears for the groomer shaft are equipped with needle bearings. Grease them every 10 hours. Shortage of grease will cause heat generation and a grating sound.

5-2.

Replenish the engine with engine oil. (A correct level will be shown when the engine is placed horizontally.) Change engine oil 5 hours after the initial operation, and every 50 hours from the second time onward. Oil : SAE30.

6. Fastening of each portion

Many parts are fastened by bolts. Bolts and nuts may be loosened some time after initial operation. Fasten them to the specified torque.

Appropriate fastening torque N.m (kgf-cm)

	Normal bolt	Heat treated bolt
M6	7.8 (80)	
M8	17.7 (180)	35.3 (360)
M10	35.3 (360)	70.6 (720)
M16	1.5-pitch left-hand thread: 35.3 (360 kgf-cm)	

7. Engine starting sequence

7-1.

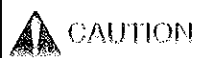

Before starting engine

Carefully read the gasoline engine operation manual before starting the engine. Check the ON/OFF positions of the engine switch lever at the front of the handle. Set the engine switch lever in the ON position, set all moving parts in the neutral position. Check for safety - covers are in position and not damaged and there is no person around the machine - before starting the engine. Do not start the engine indoors without an appropriate ventilator.

7-2.

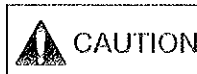

Starting the engine

- (1) Set the clutch lever in the OFF position.
- (2) Set the throttle lever in the high-speed position.
- (3) Set the engine switch lever in the ON position.
- (4) Set the strainer lever in the open position.
- (5) Pull the choke lever and pull the recoil starter, and the engine will start.
- (6) Return the choke lever.

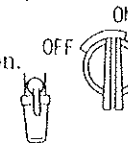

7-3.

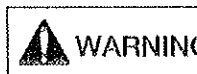

Stopping the engine (Remember the method for stopping the engine in an emergency.)

- (1) Set the clutch lever in the OFF position.
- (2) Set the throttle lever in the slow-speed position.
- (3) Set the strainer lever in the close position.
- (4) Set the engine switch lever in the OFF position.
- (5) In an emergency, immediately set the engine switch in the OFF position.

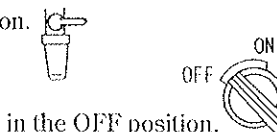

7-4.



Fuel supply



Gasoline for automobiles

- (1) Keep flame etc. away from the engine when supplying fuel. Stop the engine outdoors and allow it to cool before supplying fuel.
- (2) Keep the machine clean at all times to prevent deposition of dust, grease, or oil.

7-5.

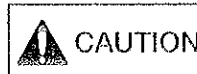

When leaving the machine

Park the machine on a flat place. Check that the engine switch lever is in the OFF position. Do not park the machine on a slope.

8. Machine operation

8-1.



Check that each portion - especially the brake and clutch - operates satisfactorily before starting machine operation. Make sure that the machine can be stopped immediately at any time. Exercise care so that you and people around the machine will not be injured.

8-2. Travelling lever

The travelling lever is provided at right in front of the handle. Push it forward, and it will enter the OFF position and stop. Pull it to your side, and it will enter the ON position, and the machine begins to travel. Move the lever slowly.

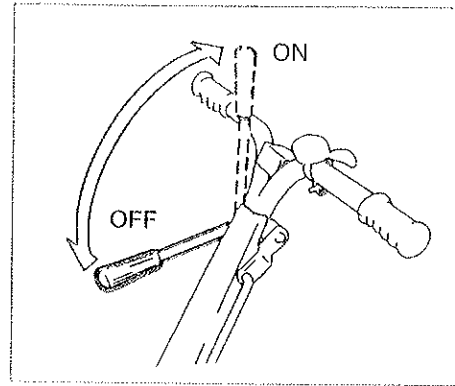

8-3. Clutch lever

The mower clutch lever is provided in the lower front position at left. Set it in the ON for engagement. Set it in the OFF position when moving the machine. The groomer clutch is also provided on a groomer gear case cover.

8-4. Adjustment of handle height

Move the handle guide plates (5-22 and 5-23) vertically to change the height of the handle according to the height of the operator. Adjust the length of the clutch rod simultaneously. Make adjustment so that the clutch spring will completely enter the clutch when the clutch is engaged.

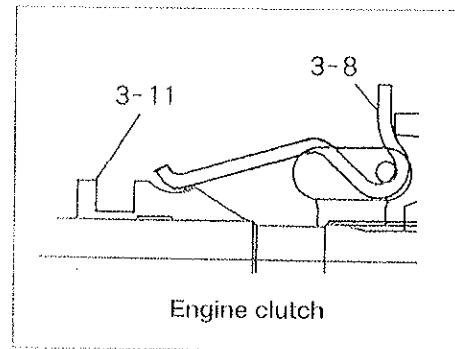

8-5. WARNING Brake lever

The brake lever is provided at right. Grip the lever, and the brake drums set on the right and left drum shafts operate simultaneously. If the braking performance is nonuniform, make adjustment for uniform operation.

8-6. Throttle lever

The throttle lever is on the left side of the handle. The lever controls the engine speed. The adjustment range is 1350-3300 rpm. The engine speed should be 3000 rpm for mowing operation.

8-7. [IMPORTANT] Adjustment of engine clutch

(1) When reinstalling the engine:

Adjust the clearance between the engine clutch and clutch facing so that it will be approx. 0.5 to 1 mm when the travelling clutch is engaged. For adjustment, loosen the four bolts that are securing the engine, and insert a thickness gauge (attached) into the front and rear. Make adjustment so that the gap will be parallel, and then fasten the bolts.

(2) After using a new machine for 10 hours or when the clutch spring is changed:

Make adjustment so that the difference in the position of the clutch plate when the clutch is engaged and disengaged will be 0.8-1 mm.

Loosen the bolt (3-10) that is securing the lever mounting base (3-7), screw in the base up to an appropriate position, and then secure the base with the bolt. (See the figure below.)

Apply grease sufficiently to the clutch and clutch mover, and check them every 10 hours.

Adjust the clutch mover so that it will be in the center of the clutch when the clutch is engaged.

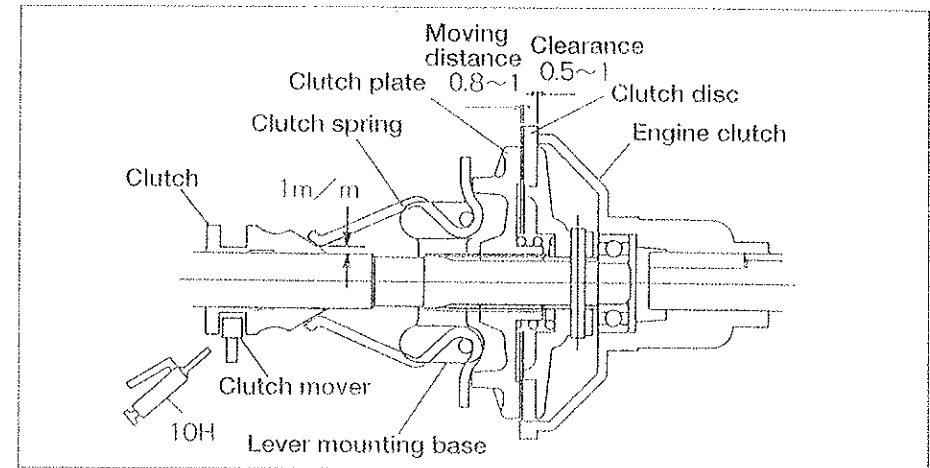

8-8. Clutch cover

The clutch cover is on the left side of the engine, covering the engine clutch. It is secured by turning the wing bolt clockwise (by 4-5 turns).

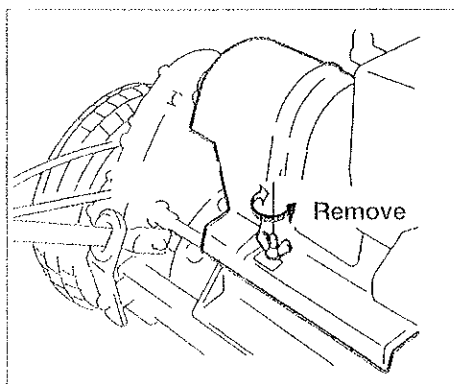

8-9. Travelling wheel

The travelling wheel is used to move the machine from green to green. Set the stand upright, hold and pull the tire and lever, and the wheel will come off.

8-10. [IMPORTANT] Adjustment of clutch rod lever

Be sure to adjust the rod length after adjusting the handle height.

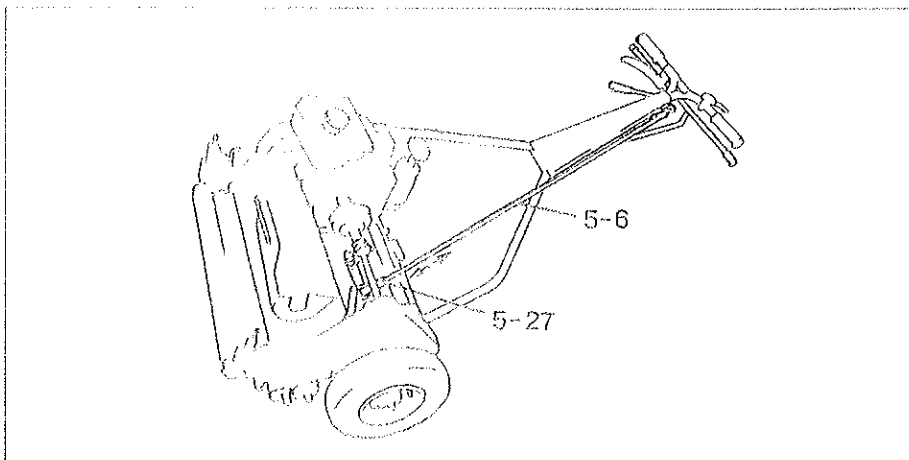

8-11. [IMPORTANT] Adjustment of mowing height

Move the front roller up or down, and the mowing height can be adjusted within the range of 4-19 mm. Use an optional bottom blade when 3 mm mowing height is desired.

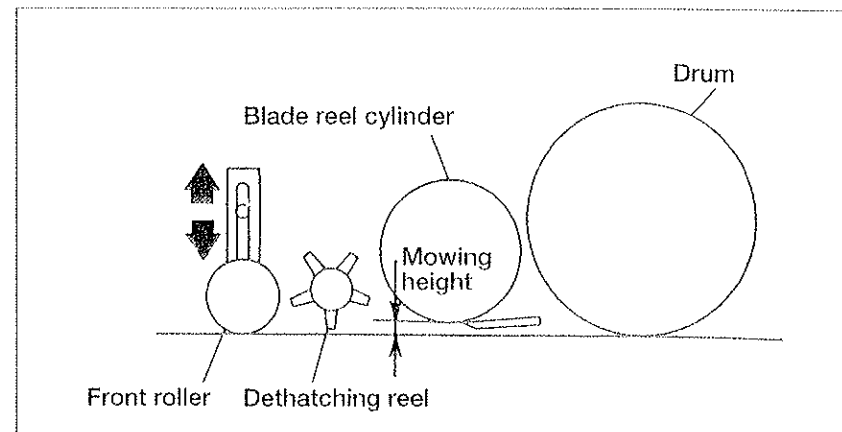

8-12. [IMPORTANT] Greasing

Fill up grease nipples with approx. 1g of grease (EXCELITE EP NO.2) every 10 hours—one or two times injection with a small manual grease pump. Needle bearings are used, so exercise care when greasing them.

Every 10 hours →

- 2 shafts on left frame
- Intermediate shaft on left frame
- Differential gear section
- Vertical gears case R&L

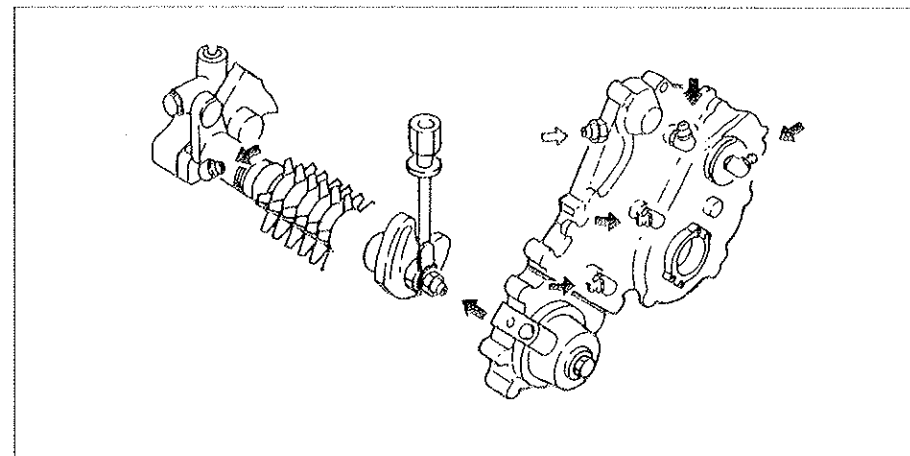

8-13. Setting the mowing height gauge and blade thickness

(1) Set the mowing height gauge at the desired height. The minimum mowing height with respect to each bottom blade thickness is shown below. (The maximum height of Teeing ground mower is 19 mm.)

	Blade thickness (mm)	Min. mowing height (mm)	Code No.	Part Name
Green	Standard blade: 2.5	3.5	K2511000050	55G bed knife No.1
			K2511000200	65G bed knife No.1
	Special No.2 for tournament: 1.8	3.0	K2511000190	55G bed knife No.2
		K2511000210	65G bed knife No.2	
	High-speed-steel-tipped blade: 3.0	4.0	K2510000060	3 Bed knife 62.5-559
			K2510000150	3 Bed knife 62.5-648.4
Teeing ground	Standard tipped blade: 5.0	7.0	K2510000160	5 Bed knife 62.5-559
			K2510000170	5 Bed knife 62.5-648.4

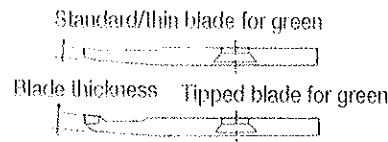

※ The minimum mowing height is the average height on the green. Lawn may be shaved when the undulation of the green is substantial. Set the mowing height slightly higher in that case.

(2) When the mowing height of 7 mm or less is desired for the teeing ground, use the green mower bottom blade.

(3) Adjust the front groomer according to the condition of the lawn before use.

※ If the groomer blades are set deeper than the ground surface, the shaft may bend.

(4) Adjust the rotary brush assy (option) on the same level as the mowing height. The brush may be worn easily when the height is too low.

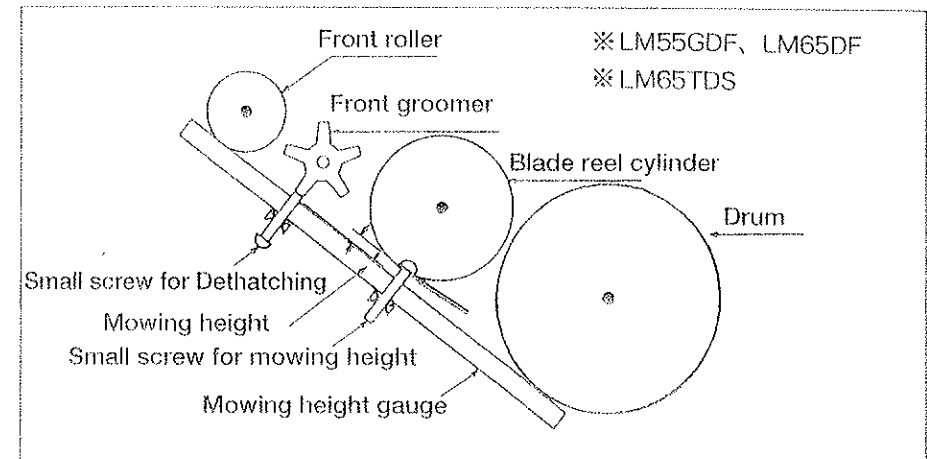

[IMPORTANT] Adjustment of front roller height

Bring the mowing height gauge into contact with the front roller and drum (as shown above), and adjust the height of the bottom blade.

- (1) Loosen the tall nut of the roller bracket, and move the front roller up or down with the mowing height adjusting screw.
- (2) Position the front roller with the mowing height gauge.
- (3) Make adjustment at both edges.
- (4) Tighten the tall nut, and secure the roller bracket.

9. Blade engagement

Grind and adjust the blade reel cylinder and bottom blade entirely so that a newspaper will be cut sharply.

9-1. [IMPORTANT] Lapping

Conduct lapping after mowing operation (before adjusting the engagement).

- (1) Check the entire portion of the blade reel cylinder to check which portion is dull. (If a newspaper cannot be cut in any portion, put in two sheets of paper to carefully check which portion is dull.)
- (2) Connect the lapping machine (RM20) or lapping handle (option) to the lapping shaft of the mower.

(3) Rotate the blade reel cylinder in the direction opposite to the mowing direction, and apply abrasive with a brush only to the portion where a newspaper was sharply cut. The portion where a newspaper was not cut is worn away. Do not apply abrasive to such portions.

※ The right side (when viewed from the front of the blade reel cylinder) of the blade reel cylinder will be worn away 3-4 times earlier than the left side. When applying abrasive to the blade reel cylinder, be sure to move the brush from left to right. (Fig.7)

Blend powder (#200-#400) and oil at the ratio of 1:3 or 1:4 to make an abrasive.

(4) Keep rotating the blade reel cylinder, and stop rotation when the contact sound disappears. Put in a newspaper again to check the blade reel cylinder entirely for the sharpness of each portion.

(5) Repeat operations (3) and (4). When the blade reel cylinder and bottom blade are in contact with each other uniformly, apply abrasive to the blade reel cylinder entirely for final lapping.

(6) After lapping, remove the abrasive with steam, etc.

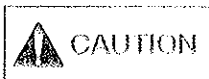

Both blade reel cylinder and bottom blade are edged. Handle them carefully.

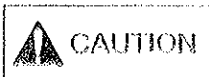

Be careful of the fingers, which turn the blade reel cylinder, when cutting a newspaper to check sharpness. Uniformly lap the right and left sides of the bottom blade in contact with the blade reel cylinder, and the life of the blade will be maximized.

9-2. [IMPORTANT] Engagement

(1) Lightly engage the blade reel cylinder and bottom blade uniformly on both sides.

(a) Uniformly adjust the bottom blade on the right and left sides. Turn the cutter adjuster (1-56) clockwise for slight engagement, and turn it counterclockwise for firm engagement. (Fig.8)

(b) Lightly engage both sides to the extent that a newspaper will be cut sharply.

When the blade reel cylinder is worn away and the spring pressure decreases, loosen the lock nut (1-48) and turn the threaded pipe (1-47) clockwise, and the spring pressure will increase. (Fig.8)

After the green mower is used for one season, the diameter of the blade reel cylinder and the thickness of the bottom blade will decrease by approx. 1 mm on average, respectively.

The thread pitch of the threaded pipe is 1 mm. Turn the threaded pipe clockwise by two turns, and appropriate spring pressure will be maintained. Use the above as guidelines.

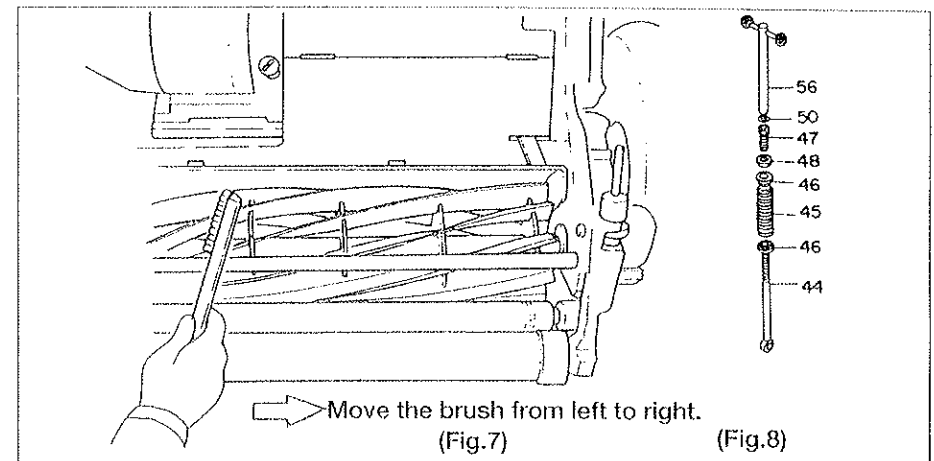

9-3. [IMPORTANT] Cam adjustment

Turn the cam bush on both sides of the bottom blade, and the blade will be raised and lowered within a maximum range of 0.3 mm. (Fig.9)

The above method is used when the edges of the blade reel cylinder and bottom blade are not in parallel.

(1) When there is a gap between the blade reel cylinder and the left frame side of the bottom blade

(a) Loosen the lock nut, and turn the left cam bush clockwise as much as the gap. Turn it clockwise by 30° to raise the bottom blade by 0.1 mm.

(b) After adjustment, firmly fasten the lock nut.

(2) When there is a gap on the right frame side, loosen the lock nut, and turn the right cam bush counterclockwise as much as the gap.

9-4. Cylindrical grinding and installation of blade reel cylinder

Cylindrically grind the blade reel cylinder when it is worn away and has become conical. (Ask the dealer you purchased the machine from for cylindrical grinding.)

9-5. [IMPORTANT] Installation of blade reel cylinder

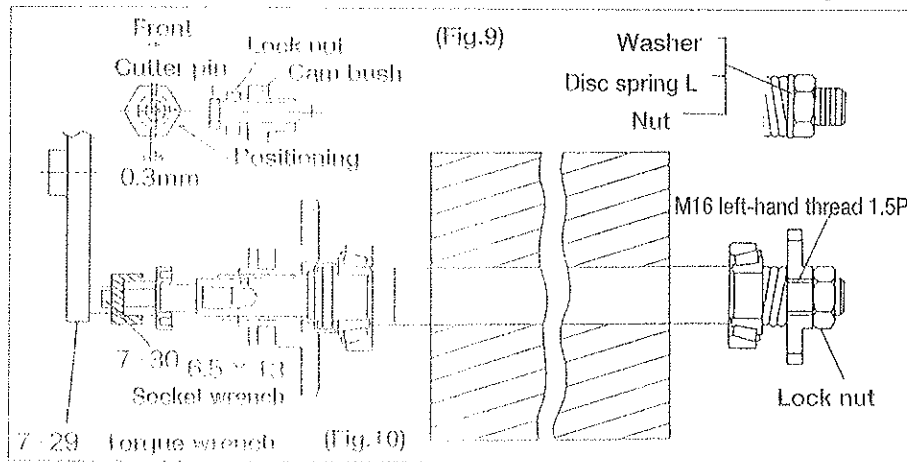

- Replace the bearing and reel shaft seal on both sides of the blade reel cylinder. Use the bearing 30204JRP6 that has the smallest error.
- Sufficiently apply grease (EXCELITE EPNO2) to the bearing and seal. (Apply grease while turning the roller. The grease will be sufficient for one season.)
- Method to fasten nut after installing the blade reel cylinder

[IMPORTANT] Completely fasten the inside nut to firmly secure the bearing. The fastening torque is 35.3 N·m (360kgf·cm). A certain preload will be applied by the spring pressure. The rotational torque of the blade reel cylinder should be 0.78 ~ 0.98 N·m (8 ~ 10kgf·cm). If it is not, check the bearing and seal.

9-6. Position of mower during maintenance

If the mower handle is left leaned on the ground for a long time during maintenance, engine oil may enter the engine combustion chamber and cause the engine to run improperly.

Be careful not to keep this position long.

10. Long-term storage

- For the engine, refer to the engine operation manual.
- Cylindrically grind the blade reel cylinder every six months.
- Replace the bearing (30204JRP6) and seal on both sides of the blade reel cylinder every season. (Replace them even if they have not been used for many hours.)
- Clean the machine, and apply grease or oil to respective sliding sections.

11. CAUTION Precautions for engine operation



For the engine, refer to the engine operation manual.

- (1) Use gasoline for automobiles as the fuel of the engine.
- (2) Completely change engine oil when the machine has been used for eight hours after the initial operation, because the machine is used under tough conditions with vibration and dust. Check the element in 15 hours, and change oil every 50 hours. The quantity of engine oil is 0.6 dm³ (0.6 ℓ). Use SAE30.
- (3) Always cover the suction port of the air cleaner with a cleaner cover bag during operation. Be sure to clean the air cleaner element before using the machine, and replace the element with a new one every 200 hours.



(4) Fire is strictly prohibited during fuel supply. Be careful of a lit cigarette. Supply fuel outdoors after the engine is stopped and cooled.

(5) Do not start the engine in a building without a proper ventilator.



(6) The muffler and the area around the exhaust port of the muffler will become hot. Do not bring gasoline, matches, dry grass, or other inflammables near hot portions.

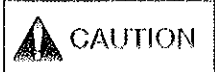

(7) Inspection before operation

Check the joint of fuel pipe, etc. for looseness or damage. Check bolts and nuts in



respective sections for looseness.

(8) Wear appropriate clothes. An apron, towel on the belt, long string, etc. will cause you to be caught in rotating parts.

(9) When the machine is to be stored for a long time exceeding 5 months, remove gasoline from the engine.

(10) Engine maintenance schedule

To keep the engine in satisfactory status at all times, be sure to conduct maintenance and inspection according to the following table:

Operation hours	Every 8 hr	Every 15 hr	Every 50 hr
Inspection/supply of engine oil	○		
Engine oil change	First time		Second time forward
Cleaning of air cleaner		○	

For details, see the engine operation manual.

12. Special optional parts (For blade reel cylinder change)

Special type

Lawn mowing impossible

12-1. Vertical dethatching reel

Instead of a blade reel cylinder, a spiral dethatching reel can be installed for dethatching.

The working depth is 2 mm underground.

※ In the case of a green mower, use wheel gears for teeing ground mower to lower the operation speed. (Reference: Parts Catalog, p.26)

12-2. Rotary brush for sweeper

Instead of a blade reel cylinder, a spiral rotary brush can be installed for dethatching, and collection of fallen leaves.

	Vertical dethatching reel		Rotary brush	
	Working width (cm)	Number of dethatching blades	Working width (cm)	Dia. of brush (cm)
LM55 Series	484	36	493	φ 135
LM65 Series	574	42	583	φ 135

Vertical blade thickness is 0.8mm. Vertical blade diameter is 128mm.

12-3. Special optional tools and reel rotational torque measuring instrument

Use ⑨ and ⑩ in the blade reel cylinder installation (Fig.10) for measurement of the rotational torque (3-10 kgf·cm) of the blade reel cylinder.

Optional tools

① Spanner: 8 × 10	K4810080102	
② Spanner: 13 × 17	K4810130172	
③ Spanner: 19 × 22	K4810190222	
④ Spanner: 24 × 27	K4810240272	
⑤ Pliers	K4830000012	
⑥ +/- screwdrivers	K4820000010	
⑦ Reel lapping handle	K6125000052	
⑧ — screwdriver fit-through	K4820000020	
⑨ Torque wrench 6-60	K4802000370	For measurement of reel rotational torque
⑩ Socket adapter 6.35 × 9.5	K4802000354	
⑪ Socket adapter 9.5 × 12.7	K4802000364	

12-4. Common Parts in Parts List

○ : Common to LM55GC

BARONESS LAWN MOWER

GREEN MOWER

LM55GD • LM55GDF
LM65GD • LM65GDF
LM65TD • LM65TDS

PARTS CATALOG

☆ Ordering parts

All parts in this parts catalog are controlled by computer. However for prevention of delivery of wrong parts, advise us of the catalog No., code No., and part name.

(Example)	Catalog No.	Code No.	Part Name	Qty
	1-1	K28055009DR	Blade reel cylinder 577-9	1

1. Blade reel cylinder/bottom blade

LM55GD · LM55GDF
LM65GD · LM65GDF LM65TD · LM65TDS

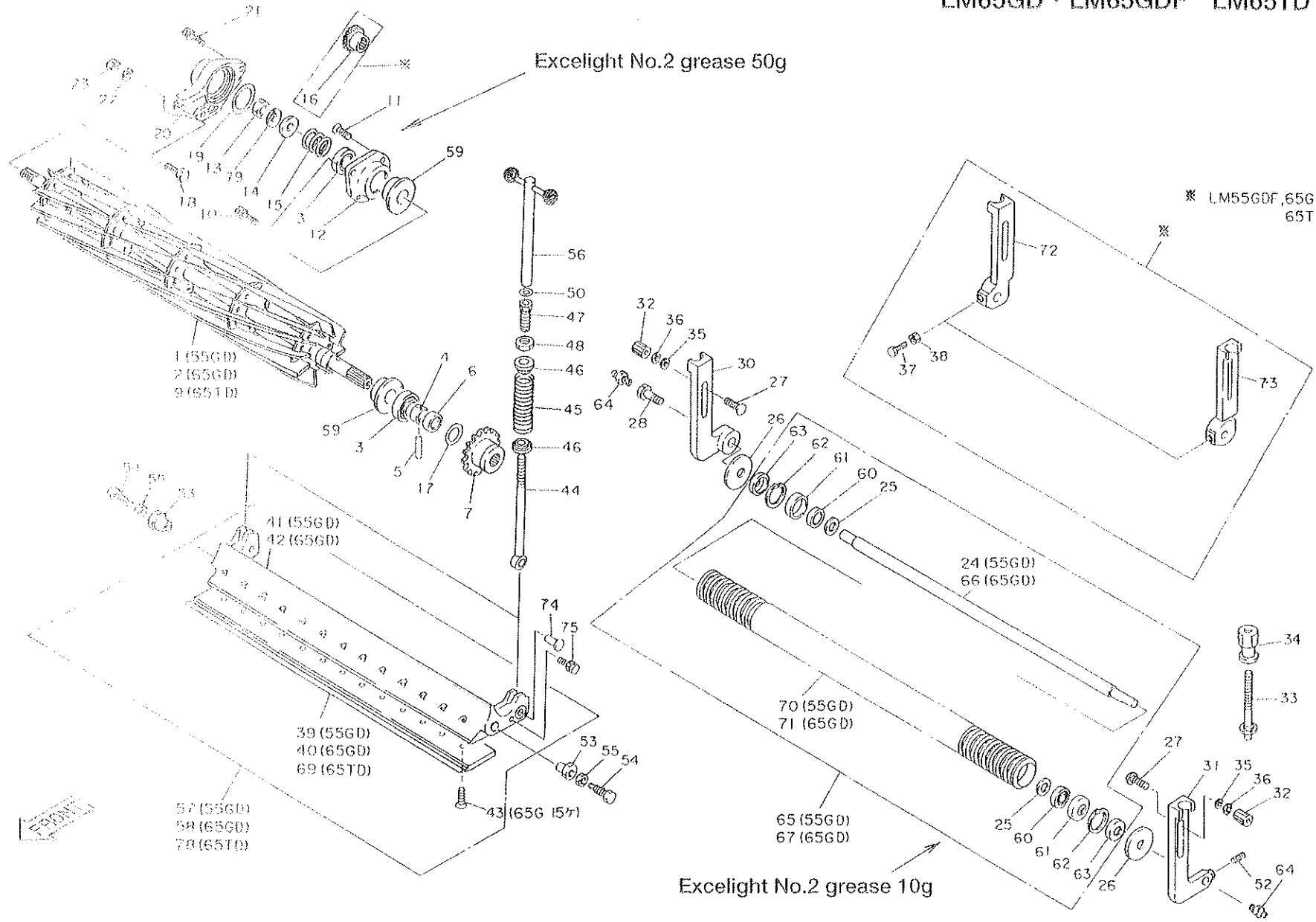

Catalog No.	Code No.	Part Name	Qty /Unit	Common Part	Retail Price
1-1	K 2 8 0 5 5 0 0 9 0 B	Blade reel cylinder 577-9	1		
1-2	K 2 8 0 6 5 0 0 9 0 B	Blade reel cylinder 646-9	1		
1-3	K 0 6 3 1 3 0 2 0 4 0	Tapered roller 30204JRP6	2	○	
1-4	K 6 2 1 3 0 0 0 0 4 0	Left bearing collar	1	○	
1-5	K 0 3 1 1 0 4 5 2 5 0	4.5 needle roller 25.8	1		
1-6	K 5 3 0 0 0 0 0 2 8 2	Fliming cover	1	○	
1-7	LM 5 5 GC--0 1 0 2 2 0	42 tooth reel gear	1	○	
1-8					
1-9	K 2 8 0 6 5 0 0 2 0 B	Blade reel cylinder 646-7	1		
1-10	K 0 0 0 7 0 8 9 2 5 2	8 bolt 25 SW	1	○	
1-11	K 0 0 4 1 0 8 9 2 0 2	8 countersunk head screw 20	3	○	
1-12	LM 5 5 GC--0 1 0 8 A 2	Right reel housing	1	○	
1-13	K 0 1 8 5 1 6 0 0 0 2	16 left-hand threaded nut 3P1.5	1		
1-14	K 5 0 1 2 0 1 6 2 8 2	2SPCC washer 1628	1		
1-15	K 1 0 0 0 0 0 0 7 4 0	3.2 compression spring 26.9 22	1		
1-16	LM 5 5 GDF 1 2 0 6 Z 0	23 tooth reel gear	1		
1-17	K 0 8 8 0 0 1 8 0 0 0	O-ring F18	1	○	
1-18	K 0 0 0 0 0 8 9 4 5 2	8 bolt 45	1	○	
1-19	K 0 8 8 2 0 4 5 0 0 0	O-ring G45	1	○	
1-20	LM 5 5 GC--1 2 1 1 Z 0	Cover	1	○	
1-21	K 0 0 0 7 0 8 9 2 5 2	8 bolt 25 SW	1	○	
1-22	K 0 2 1 3 0 8 9 0 0 1	8 disc spring washer 1H	1	○	
1-23	K 0 1 0 0 0 8 0 0 0 2	8 nut	1	○	
1-24	K 6 1 3 1 0 0 0 1 2 2	Front roller shaft 596	1	○	
1-25	K 5 0 5 1 0 1 5 2 8 0	1C5191P washer 1528	2	○	
1-26	K 5 0 5 1 0 1 5 4 7 0	1C5191P washer 1547	2	○	
1-27	K 0 0 2 5 0 8 0 3 5 2	8 square-based round-head bolt 35	2	○	
1-28	K 6 0 8 3 0 0 0 0 4 3	15 extension pin 19	1	○	
1-29					
1-30	LM 5 5 GD--0 4 0 8 Z D	Right roller bracket	1	○	
1-31	LM 5 5 GD--0 4 0 5 Z D	Left roller bracket	1	○	
1-32	K 0 1 4 9 0 8 3 2 9 2	8 tall nut 20	2	○	
1-33	K 7 9 0 0 0 0 0 0 5 0	Roller adjusting screw	2	○	
1-34	K 6 0 8 4 0 0 0 0 6 3	Roller adjuster	2	○	
1-35	K 5 0 1 2 0 0 8 1 8 3	2SPCC washer 818	2	○	

○: Parts common to LM55GC

Catalog No.	Code No.	Part Name	Qty /Unit	Common Part	Retail Price
1-36	K 0 2 1 3 0 8 0 0 0 1	8 disc spring washer 1H	2	○	
1-37	K 0 0 0 0 0 6 0 2 0 2	6 bolt 20	2	○	
1-38	K 0 1 0 0 0 6 0 0 0 2	6 nut	2	○	
*1-39	K 2 5 1 1 0 0 0 0 5 0	55G bottom blade No. 1	1	○	
*1-40	K 2 5 1 1 0 0 0 2 0 0	65G bottom plate No. 1	1	○	
*1-41	LM 5 5 GC--0 5 0 8 Z R	Bottom blade base	1	○	
*1-42	LM 6 5 GC--0 5 0 8 Z R	Bottom blade base	1	○	
1-43	K 0 0 7 1 0 0 0 2 2 2	6 heat treated countersunk head screw 12	13(15)	○	
1-44	K 6 5 1 1 0 0 0 0 6 2	Cutter adjusting bolt 205	2	○	
1-45	K 1 0 0 0 0 0 0 2 8 8	5 compression spring 25116	2	○	
1-46	K 6 2 0 6 0 0 0 0 5 2	Spring receiver	4	○	
1-47	K 6 0 8 1 0 0 0 0 3 2	Threaded pipe	2	○	
1-48	K 0 1 6 0 0 0 0 1 2 2	Cutter adjusting lock nut	2	○	
1-49					
1-50	K 5 0 1 1 0 1 0 1 6 2	1SPCC washer 1016	2	○	
1-51					
1-52	K 0 0 2 8 0 6 0 1 0 0	6 stainless hollow set 10	2	○	
1-53	K 6 0 1 0 0 0 0 0 1 0	Cam bush	2	○	
1-54	K 6 0 8 2 0 0 0 0 1 0	Cutter pin R	2	○	
1-55	K 0 1 6 0 0 0 0 1 1 2	Lock nut	2	○	
1-56	K 1 3 3 0 0 0 0 0 4 0	Cutter adjuster ass'y	2	○	
1-57	LM 5 5 GC--0 5 0 2 Z 0	Bottom blade COMP	1	○	
1-58	LM 6 5 GC--0 5 0 2 Z 0	Bottom blade COMP	1	○	
1-59	K 0 8 3 0 0 0 0 0 2 0	Oil seal 254210	2	○	
1-60	K 0 6 1 6 0 6 2 0 2 0	Bearing 6202 2NSE	2	○	
1-61	K 0 8 6 1 0 0 0 0 3 0	Oil seal 6202	2	○	
1-62	K 0 4 0 2 0 4 2 0 0 1	Stop ring R42	2	○	
1-63	K 0 8 6 1 0 0 0 0 2 0	Oil seal TA1542.38	2	○	
1-64	K 1 4 4 0 0 0 0 0 1 2	Grease nipple	2	○	
*1-65	K 8 0 2 1 0 0 0 3 1 0	Grooved roller ass'y 577	1	○	
*1-66	K 6 1 3 1 0 0 0 1 3 2	Front roller shaft 685	1	○	
*1-67	K 8 0 2 1 0 0 0 3 2 0	Grooved roller ass'y 666	1	○	
1-68					
*1-69	K 2 5 1 0 0 0 0 1 7 0	5 bottom blade 62.5-648.4	1		
1-70	K 6 2 0 2 0 0 0 3 9 D	9.9 grooved roller 577	1	○	

1. Blade reel cylinder/bottom blade

LM55GD • LM55GDF
LM65GD • LM65GDF LM65TD • LM65TDS

1. Blade reel cylinder/bottom blade

LM55GD • LM55GDF
LM65GD • LM65GDF LM65TD • LM65TDS

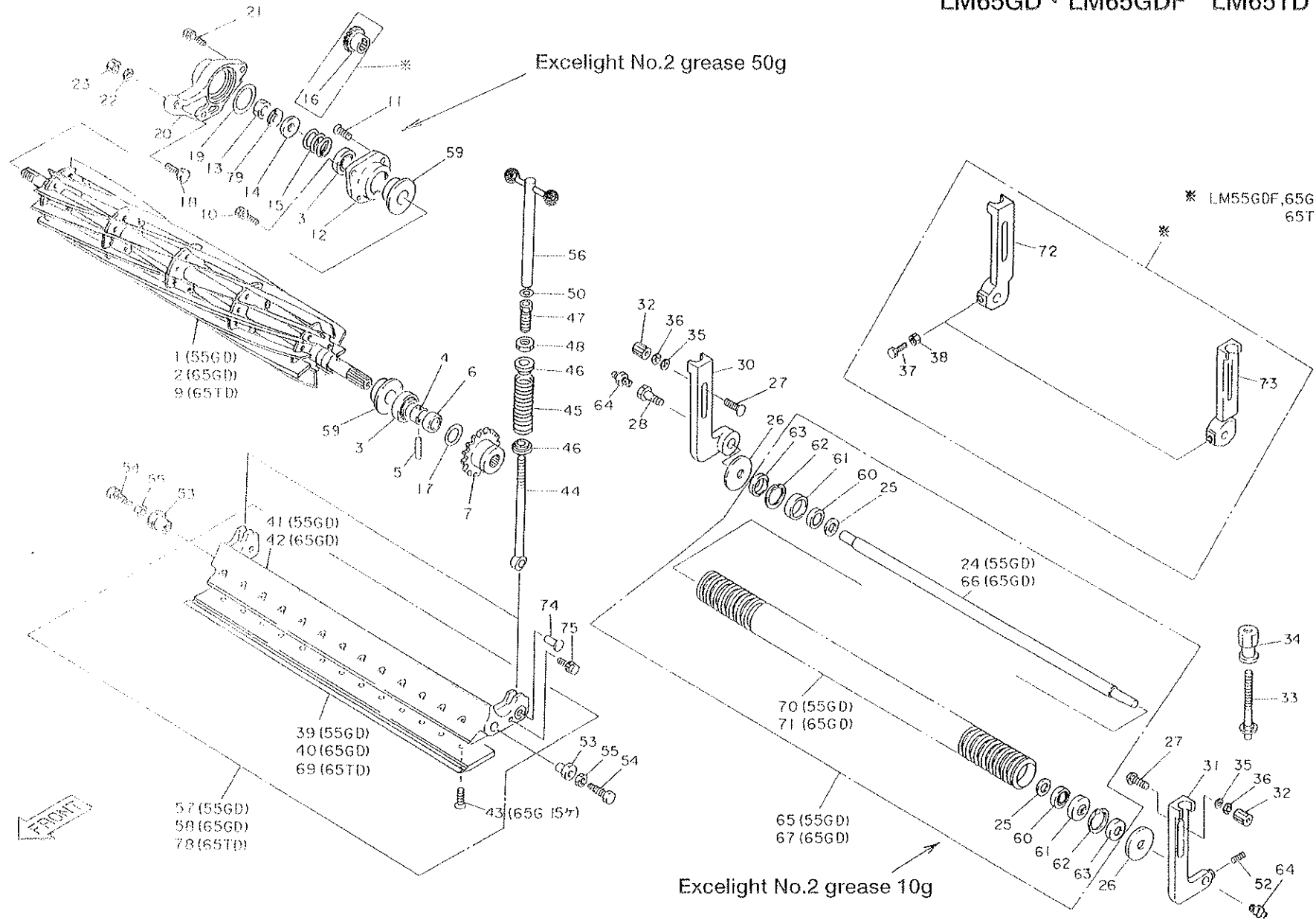

Catalog No.	Code No.	Part Name	Qty /Unit	Common Part	Retail Price
*1-71	K 6 2 0 2 0 0 0 4 0 D	9.9 grooved roller 666	1	○	
1-72	K 6 9 0 4 0 0 0 0 7 0	Right roller bracket	1	○	
1-73	K 6 9 0 4 0 0 0 0 6 0	Left roller bracket	1	○	
1-74	K 6 0 3 0 1 0 0 2 3 3	10 flat head pin 23	2	○	
1-75	K 0 0 0 7 0 6 0 1 5 2	6 bolt 15 SW	2	○	
1-76					
1-77					
*1-78	L M 6 5 T C - 0 5 0 2 Z 0	Bottom blade COMP	1	○	
1-79	K 0 2 1 0 1 6 0 0 0 1	16 disc spring L	1		

○: Parts common to LM55GC

Catalog No.	Code No.	Part Name	Qty /Unit	Common Part	Retail Price

1. Blade reel cylinder/bottom blade

LM55GD • LM55GDF
LM65GD • LM65GDF LM65TD • LM65TDS

2. Drum wheel

LM55GD • LM55GDF
 LM65GD • LM65GDF LM65TD • LM65TDS

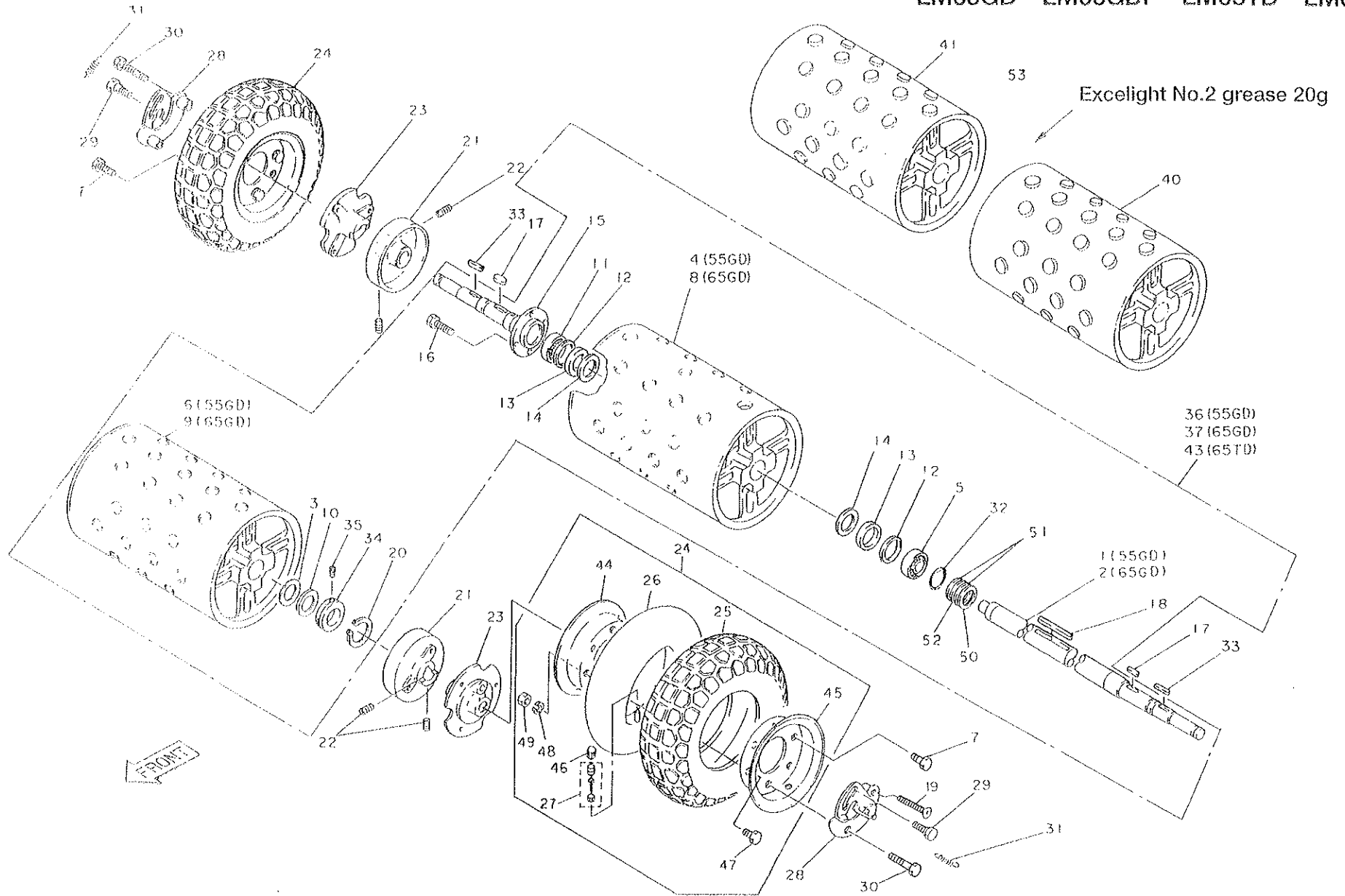

Catalog No.	Code No.	Part Name	Qty /Unit	Common Part	Retail Price
2-1	LM55GD-0231Z2	Left drum axle	1		
2-2	LM65GD-0231Z2	Left drum axle	1		
2-3	K5050325420	0.3C5191P washer 25.442	1~2	○	
※2-4	LM55GD-0237A0	Right drum	1		
2-5	K0611060050	Bearing 6005RDC3	1	○	
※2-6	LM55GD-0235Z0	Left drum	1		
2-7	K0006080162	8 bolt 16S	2	○	
※2-8	LM65GD-0237Z0	Right drum	1		
※2-9	LM65GD-0235Z0	Left drum	1		
2-10	K5051025420	1C5191P washer 25.442	1	○	
2-11	K0601062040	Bearing 6204C3	1		
2-12	LM55GD-0252Z2	40STKM collar 46.54	2		
2-13	K0822547080	Oil seal MMSA25478	2		
2-14	LM55GD-0251Z2	4.5SPHC washer 2547	2		
2-15	LM55GD-0232Z2	Right drum axle	1		
2-16	K0006080252	8 bolt 25 S	4	○	
2-17	K0500505160	5 both-end round key 516	2	○	
2-18	K0500505350	5 both-end round key 535.5	1	○	
2-19	K0041080352	8 + countersunk head screw 35	2	○	
2-20	K0401042001	Stop ring S42	1	○	
2-21	LM55GD-0238Z3	Brake drum	2	○	
2-22	K0023080101	8 hollow set 10	4	○	
2-23	LM55GD-0239ZD	Wheel mounting seat	2	○	
2-24	K2020000050	Tire 4.10/3.50-6 ass'y	2	○	
2-25	K2021000030	Tire 4.10/3.50-6	2	○	
2-26	K2091000220	Tube 4.10/3.50-6	2	○	
2-27	K2092000020	Valve core NO900	2	○	
2-28	LM55GB-0242G2	Wheel mounting plate	2	○	
2-29	K6082000023	8 bolt 10	2	○	
2-30	K0006080402	8 bolt 40 S	2	○	
2-31	K1030000068	1.5U hook spring 8.535.5	2	○	
2-32	K0880040000	O-ring P40	1	○	
2-33	K0500505280	5 both-end round key 528	2	○	
2-34	LM55GB-0249Z2	Drum collar	1	○	
2-35	K0071000772	Drum collar stopper	1	○	

○: Parts common to LM55GC

Catalog No.	Code No.	Part Name	Qty /Unit	Common Part	Retail Price
※2-36	LM55GD-0236Z0	Drum ass'y	1		
※2-37	LM65GD-0236Z0	Drum ass'y	1		
2-38					
2-39					
※2-40	LM65TD-0235Z0	Left drum (65TD)	1		
※2-41	LM65TD-0237Z0	Right drum (65TD)	1		
2-42					
※2-43	LM65TD-0236Z0	Drum ass'y (65TD)	1		
2-44	K209000050L	Wheel 3SP-6	2	○	
2-45	K209000051L	Wheel 3SP-6 with valve hole	2	○	
2-46	K2093000010	Valve cap	2	○	
2-47	K0000080122	8 bolt 12	6	○	
2-48	K0200080002	8S washer	6	○	
2-49	K0100080002	8 nut	6	○	
2-50	K5050340520	0.3C5191P washer 4052	1	○	
2-51	K5051040520	1C5191P washer 4052	2	○	
2-52	K5041040520	1SUS washer 4052	1	○	
2-53	K2931000000	Excelite EP No. 2	20g	○	

2. Drum wheel

LM55GD • LM55GDF
LM65GD • LM65GDF LM65TD • LM65TDS

3. Engine clutch

LM55GD · LM55GDF
LM65GD · LM65GDF LM65TD · LM65TDS

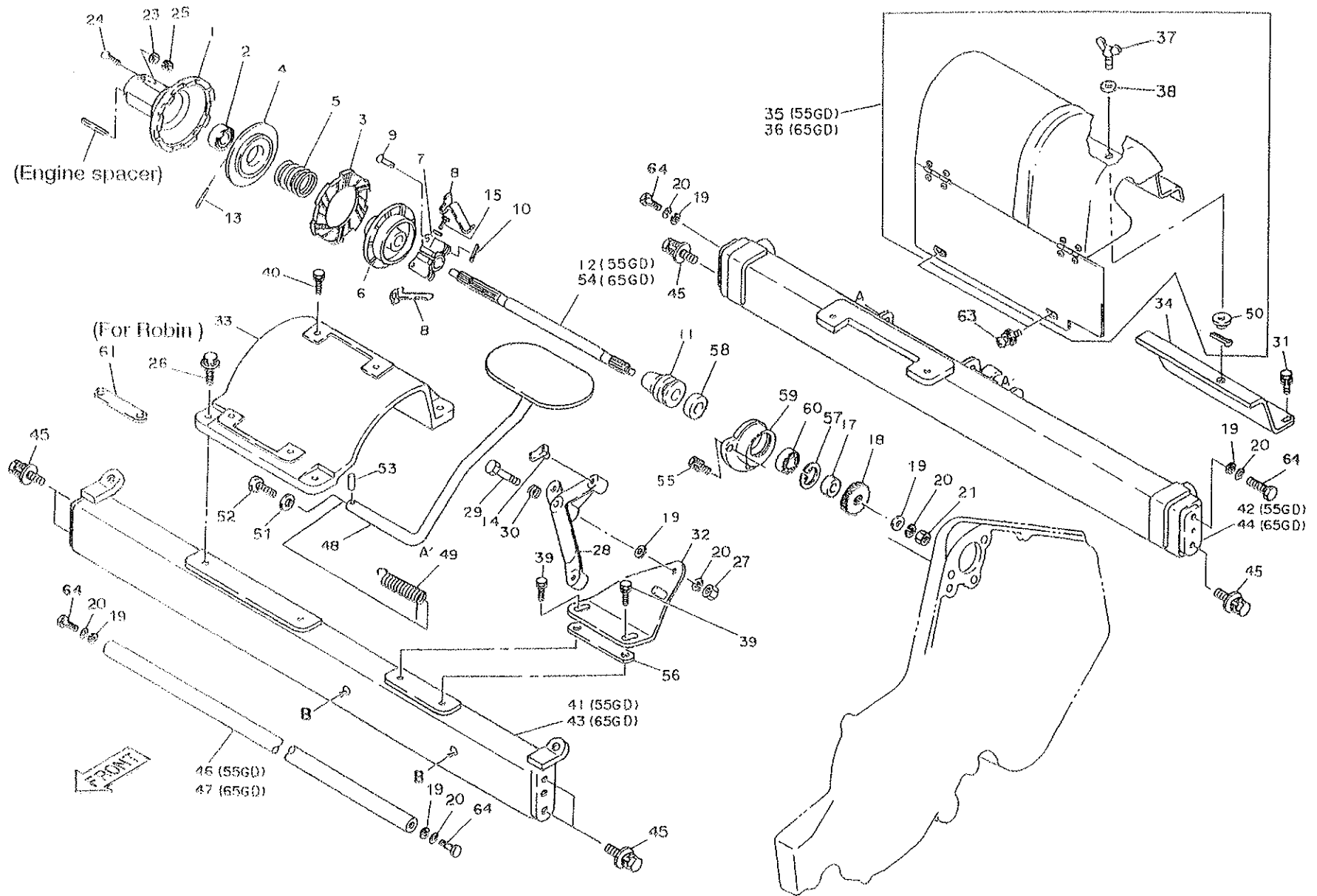

Catalog No.	Code No.	Part Name	Qty /Unit	Common Part	Retail Price
3-1	K 6 9 1 1 0 0 0 0 5 0	Engine clutch	1	○	
3-2	K 0 6 1 6 0 6 2 0 2 0	Bearing 6202NSEC3	1	○	
3-3	K 1 8 1 0 0 0 0 0 3 0	Clutch disc	1	○	
3-4	K 6 9 1 1 0 0 0 0 4 2	Disc receiver 15	1	○	
3-5	K 1 0 0 0 0 0 0 1 6 0	3.5 compression spring 3415	1	○	
3-6	K 6 9 1 1 0 0 0 0 2 2	Clutch plate	1	○	
3-7	K 6 3 1 0 0 0 0 0 1 2	Lever mounting base	1	○	
3-8	K 1 0 9 0 0 0 0 0 1 0	Clutch spring	2	○	
3-9	K 6 0 4 0 0 6 0 2 8 2	6 round head pin 28	2	○	
3-10	K 0 3 0 0 0 2 0 2 0 2	2 collar pin 20	2	○	
3-11	K 6 3 1 1 0 0 0 0 1 2	Clutch	1	○	
3-12	K 6 1 0 0 0 0 0 0 2 3	Engine clutch shaft 303 55G	1	○	
3-13	K 0 3 1 0 0 5 0 4 0 2	5 taper pin 40	1	○	
3-14	K 6 3 1 0 0 0 0 0 2 2	Clutch mover	1	○	
3-15	K 0 0 1 3 0 6 0 2 5 1	6 heat treated bolt 25	1	○	
3-16			1	○	
3-17	K 6 2 1 2 0 0 1 0 6 0	17.1STKM collar 2214	1	○	
3-18	K 6 1 8 6 0 0 0 0 2 0	16-tooth gear	1	○	
3-19	K 5 0 0 2 1 0 0 0 0 2	10 washer 22	5	○	
3-20	K 0 2 1 3 1 0 0 0 0 3	10 disc spring washer 1H	6	○	
3-21	K 0 1 6 0 0 0 0 2 8 2	10 nut 3P10H1	1	○	
3-22	K 5 0 0 2 0 8 0 0 0 2	8 washer	1	○	
3-23	K 5 0 0 0 0 6 0 0 0 2	6 washer	3	○	
3-24	K 0 0 0 0 0 6 0 3 0 2	6 bolt 30	1	○	
3-25	K 0 1 4 3 0 6 0 0 0 2	6 nut with disc spring	4	○	
3-26	K 0 0 0 7 0 8 0 3 0 2	8 bolt 30 SW	4	○	
3-27	K 0 1 0 1 1 0 0 0 0 2	10 nut 2	1	○	
3-28	K 6 9 1 1 0 0 0 0 3 2	Clutch L-shaped lever	1	○	
3-29	K 0 0 0 3 1 0 0 5 0 2	10 bolt 50	1	○	
3-30	K 1 0 0 0 0 0 0 2 0 8	2 compression spring 1514	1	○	
3-31	K 0 0 0 7 0 8 0 1 5 2	8 bolt 15 SW	2	○	
3-32	LM 5 5 GC--0 7 1 1 A R	L-shaped lever mounting bracket	1	○	
3-33	K 6 8 1 0 0 0 0 0 6 0	Engine base M	1	○	
3-34	K 9 1 0 0 0 0 0 0 8 0	Clutch cover rear COMP	1	○	
3-35	K 9 1 0 0 0 0 0 0 6 0	Clutch cover ass'y 265	1	○	

○: Parts common to LM55GC

Catalog No.	Code No.	Part Name	Qty /Unit	Common Part	Retail Price
3-36	K 9 1 0 0 0 0 0 1 2 0	Clutch cover ass'y 325	1		
3-37	K 0 0 7 1 0 0 0 8 8 3	8 wing bolt with hole	1		
3-38	K 5 0 0 0 0 8 0 0 0 3	8 washer	2	○	
3-39	K 0 0 0 7 0 8 0 2 0 2	8 bolt 20 SW	2	○	
3-40	K 0 0 0 7 0 8 0 4 0 2	8 bolt 40 SW	4	○	
3-41	LM 5 5 GC--0 7 1 3 Z R	Front frame stay	1	○	
3-42	LM 5 5 GD--0 7 1 4 Z R	Rear frame stay	1		
3-43	LM 6 5 GC--0 7 1 3 Z R	Front frame stay	1	○	
3-44	LM 6 5 GD--0 7 1 4 Z R	Rear frame stay	1		
3-45	K 0 0 8 0 1 0 0 4 0 3	10 bolt 40HW	6	○	
3-46	LM 5 5 GC--0 5 1 0 Z 3	Front stay pipe	1	○	
3-47	LM 6 5 GC--0 5 1 0 Z 3	Front stay pipe	1	○	
3-48	K 7 8 9 9 0 0 0 4 1 D	Stand	1		
3-49	K 1 0 9 0 0 0 0 0 2 9	Stand spring R	1	○	
3-50	K 4 0 3 1 0 0 0 2 5 0	10 staged rubber 224.5	1		
3-51	K 5 0 1 2 3 0 6 2 5 3	23SPCC washer 625	1	○	
3-52	K 0 0 0 6 0 6 0 1 5 2	6 bolt 15S	1	○	
3-53	K 0 3 2 0 0 4 0 2 2 1	4 spring pin 22	1	○	
3-54	K 6 1 0 0 0 0 0 0 6 9	Engine clutch shaft 363 65G			
3-55	K 0 0 0 7 0 8 0 2 5 2	8 bolt 25 SW	3	○	
3-56	LM 5 5 GC--0 7 4 8 Z R	L-shaped lever mounting bracket spacer	1	○	
3-57	K 0 4 0 2 0 4 0 0 0 1	Stop ring R40	1	○	
3-58	K 0 8 1 1 9 3 0 0 7 0	Oil seal MHS19307	1		
3-59	LM 5 5 GC--0 3 0 3 A R	Clutch shaft housing	1	○	
3-60	K 0 6 1 6 0 6 2 0 3 0	Bearing 62032NS EC3	1		
3-61	LM 6 5 GC--0 7 4 7 Z 3	Engine spacer (for ROBIN EY15D)	2		
3-62					
3-63	K 0 0 4 4 0 6 0 1 5 2	6 + round head screw 15	8	○	
3-64	K 0 0 7 1 0 0 0 5 9 3	M10 knock bolt 40	4	○	
3-65	K 9 1 0 0 0 0 0 0 6 0	Clutch cover 265 Ass'y	1		

3. Engine clutch

LM55GD • LM55GDF
LM65GD • LM65GDF LM65TD • LM65TDS

4. Frame/transmission-1

LM55GD · LM55GDF
LM65GD · LM65GDF LM65TD · LM65TDS

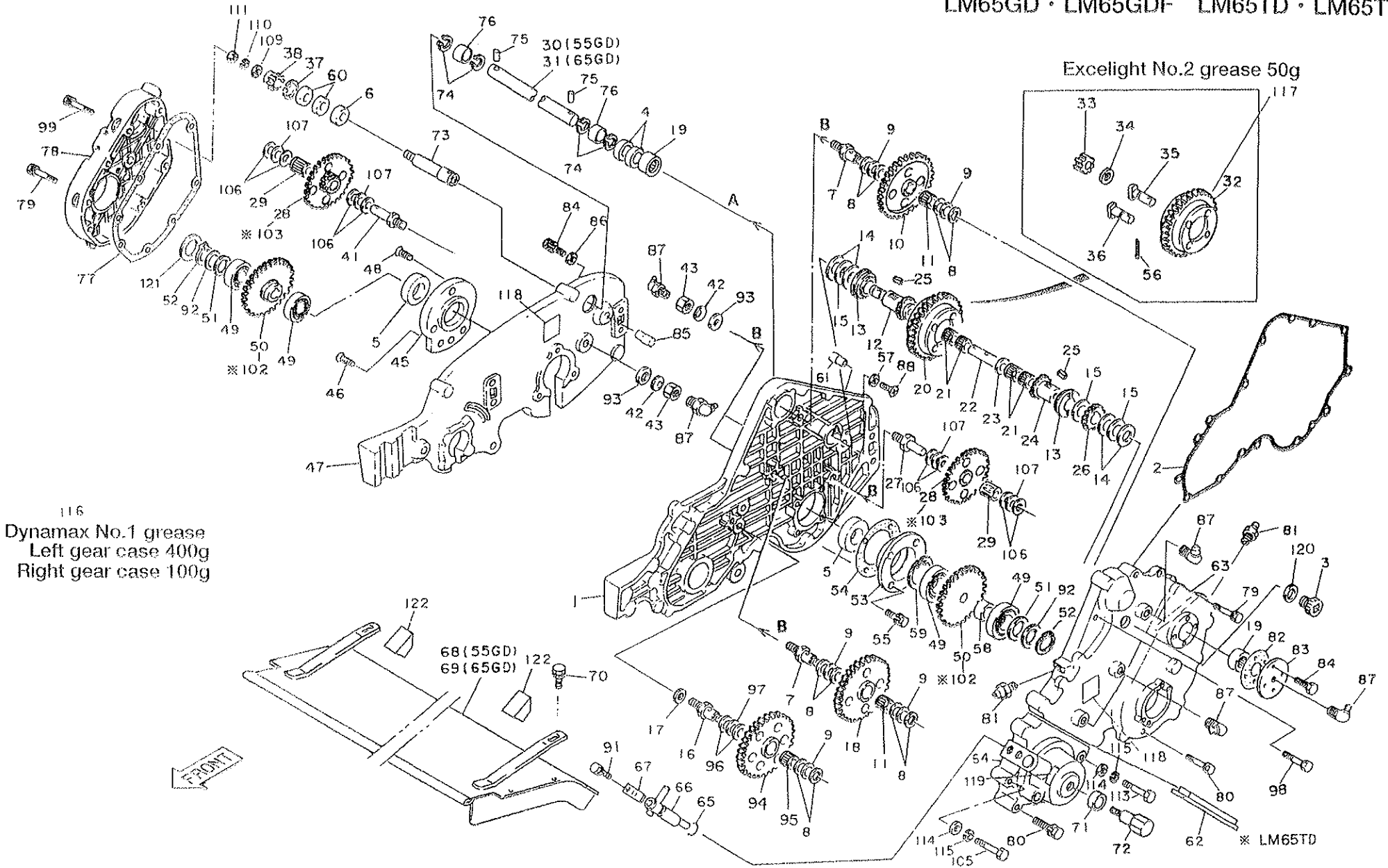

116
Dynamax No.1 grease
Left gear case 400g
Right gear case 100g

Excelight No.2 grease 50g

FRONT

* LM65TD

Catalog No.	Code No.	Part Name	Qty /Unit	Common Part	Retail Price
4-1	LM55GC-0601ER	Left frame	1		
4-2	LM55GC-0606Z0	Large packing	1		
4-3	K1400000010	Oil tap 18	1		
4-4	K0870182640	Needle seal OS18264	2	○	
4-5	K0830000020	Oil seal 254210	2	○	
4-6	K0802030050	Oil seal MH20305	1	○	
4-7	LM55GB-0201A0	Second shaft	2	○	
4-8	K5051013280	1C5191P washer 1328	10		
4-9	K5020813280	0.8NBS55 washer 1328	5		
4-10	LM55GC-0202Z0	51-tooth gear	1		
4-11	K0701317120	Needle KT131712	2	○	
4-12	LM55GB-0210A3	Right 16-tooth differential gear	1	○	
4-13	K6202000140	Differential gear bearing	2	○	
4-14	K5051022300	1C5191P washer 2230	4		
4-15	K5020822300	0.8NBS55 washer 2230	3		
4-16	LM55GC-0102Z0	Reel intermediate shaft	1		
4-17	K0211120001	12 disc spring H	1	○	
4-18	LM55GC-0203Z0	44-tooth gear	1		
4-19	K0722210000	Needle TA2210Z	2	○	
4-20	K8000000030	50-tooth differential gear ass'y	1	○	
4-21	K0701013100	Needle KT101310	4	○	
4-22	K6150000150	10 differential pin 55	1	○	
4-23	K5051010220	1C5191P washer 1022	1		
4-24	LM55GB-0209C0	Left 16-tooth differential gear	1	○	
4-25	K0520504060	5 one-end round key 46.3	2	○	
4-26	LM55GB-0214A0	Left 18-tooth gear	1	○	
4-27	LM55GB-0218A0	Left frame 4-shaft	1	○	
4-28	LM55GB-0219C0	46-tooth 16-tooth gear	2		
4-29	K0711317200	Needle KTW131720	2	○	
4-30	LM55GC-0225Z8	Transmission shaft	1		
4-31	LM65GC-0225Z8	Transmission shaft	1		
4-32	K7001000020	50-tooth differential gear	1	○	
4-33	K6191000040	Differential pinion gear 12	4	○	
4-34	K6211000180	7SGP collar 10.57	2	○	
4-35	K6033000060	Differential pin 7.5	2	○	

○: Parts common to LM55GC

Catalog No.	Code No.	Part Name	Qty /Unit	Common Part	Retail Price
4-36	K6033000070	Differential pin 15	2	○	
4-37	K4020350001	Stop ring R35	1	○	
4-38	K6188000010	Threaded 18-tooth gear M2	1		
4-39					
4-40					
4-41	LM55GB-0228A0	Right gear intermediate shaft	1	○	
4-42	K0211100001	10 disc spring H	4	○	
4-43	K0160000282	10 nut 3P1OH1	4	○	
4-44					
4-45	LM55GB-0229B0	Right drum housing	1	○	
4-46	K0041060202	6 + countersunk head screw 20	2	○	
4-47	LM55GC-0602FR	Right frame	1	○	
4-48	K0041080202	8 + countersunk head screw 20	3	○	
4-49	K0601062040	Bearing 6204C3	4	○	
4-50	LM55GB-0223Z0	48-tooth axle gear	2		
4-51	K5011020282	1SPCC washer 2028	4	○	
4-52	K0401020001	Stop ring S20	2	○	
4-53	LM55GB-0222Z0	Left drum axle housing	1	○	
4-54	LM55GB-0223A0	Left drum axle housing packing	1	○	
4-55	K0007080252	8 bolt 25 SW	4	○	
4-56	K0300025162	2.5 cotter pin 16	4	○	
4-57	LM55GB-0614Z3	Handle pin washer	1	○	
4-58	LM55GB-0234A0	Left collar	1	○	
4-59	K0402047001	Stop ring R47	2	○	
4-60	K0616062020	Bearing 62022NSEC3	2	○	
4-61	K6155000152	Handle mounting pin L	1	○	
4-62	LM55GC-0608Z0	Joint packing	1	○	
4-63	LM55GC-0603ZR	Large cover	1	○	
4-64	LM55GD-0604ZR	Small cover	1	○	
4-65	K0880015000	O-ring P15	1	○	
4-66	K7321000093	Clutch handle	1	○	
4-67	K1090000058	Clutch retainer spring	1	○	
4-68	LM55GB-0509CR	Reel cover	1	○	
4-69	LM65GB-0509CR	Reel cover	1	○	
4-70	K0007080152	8 bolt 15 SW	2	○	

4. Frame/transmission-1

LM55GD • LM55GDF
LM65GD • LM65GDF LM65TD • LM65TDS

4. Frame/transmission-2

LM55GD · LM55GDF
LM65GD · LM65GDF LM65TD · LM65TDS

Excelight No.2 grease 50g

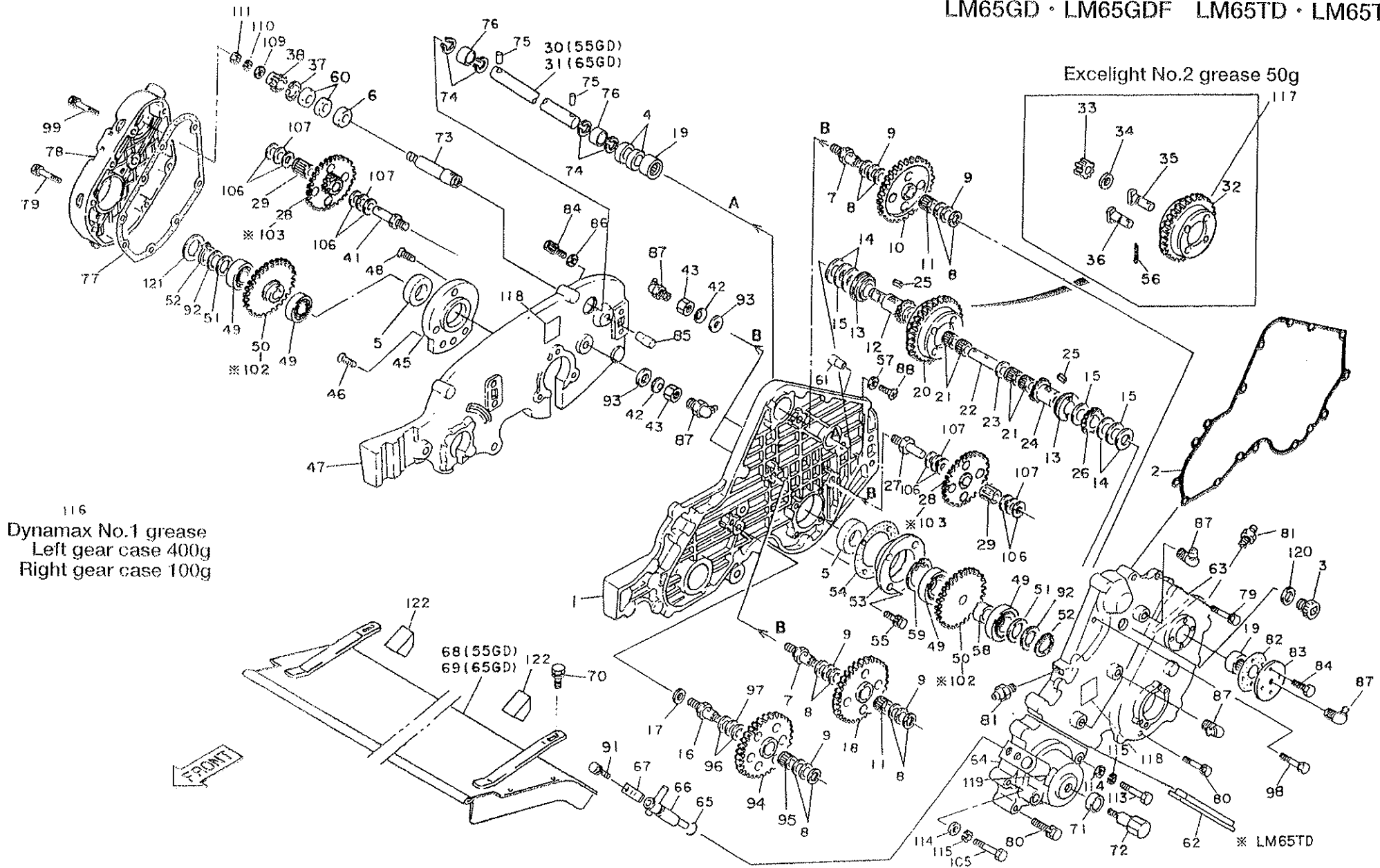

116
Dynamax No.1 grease
Left gear case 400g
Right gear case 100g

FRONT

* LM65TD

○: Parts common to LM55GC ※: LM65TD

Catalog No.	Code No.	Part Name	Qty /Unit	Common Part	Retail Price
4-71	K 0 8 2 1 2 2 8 0 7 0	Oil seal MHS A12287	1	○	
4-72	K 0 0 7 1 0 0 0 8 7 8	10 special bolt 35	1		
4-73	K 6 1 2 2 0 0 0 1 8 8	Right transmission shaft	1		
4-74	K 0 4 0 3 0 1 8 0 0 1	Round stop ring S18	3	○	
4-75	K 0 3 1 1 0 4 0 1 7 0	4 needle roller 17.8	2	○	
4-76	L M 5 5 G B - 0 2 2 4 Z 2	Differential extension shaft collar	2	○	
4-77	L M 5 5 G B - 0 6 0 7 A 0	Right case packing	1	○	
4-78	L M 5 5 G D - 0 6 0 5 Z R	Right gear cover	1	○	
4-79	K 0 0 0 7 0 6 0 5 0 2	6 bolt 50 SW	13	○	
4-80	K 0 0 0 7 0 6 0 6 0 2	6 bolt 60 SW	6	○	
4-81	K 1 4 4 0 0 0 0 0 1 2	Grease nipple	2	○	
4-82	L M 5 5 G B - 0 2 0 8 Z 0	3-shaft packing	2	○	
4-83	L M 5 5 G B - 0 2 1 7 Z 0	Bearing retainer	1	○	
4-84	K 0 0 0 7 0 6 0 1 5 2	6 bolt 15 SW	6	○	
4-85	K 6 1 5 5 0 0 0 0 4 2	Handle mounting pin R	1	○	
4-86	K 5 0 1 2 3 0 6 2 0 2	2.3SPCC washer 620	1	○	
4-87	K 1 4 4 0 0 0 0 0 2 2	C-shaped grease nipple	6	○	
4-88	K 0 0 4 1 0 6 0 1 2 2	6 + countersunk head screw 12	1	○	
4-89					
4-90					
4-91	K 0 0 2 7 0 6 0 1 2 2	6 + hole upset bolt 12 S	1	○	
4-92	K 5 0 1 0 3 2 0 2 8 3	0.3SPCC washer 2028	4	○	
4-93	K 5 0 0 0 1 0 0 0 0 2	10 washer	4	○	
4-94	L M 5 5 G C - 0 1 0 3 Z 0	44-tooth gear	1		
4-95	K 0 7 0 1 5 1 9 1 8 0	Needle KT151918	1	○	
4-96	K 5 0 5 1 0 1 5 2 8 0	1C5191P washer 1528	2	○	
4-97	K 5 0 2 0 8 1 5 2 8 0	0.8NBS55 washer 1528	1	○	
4-98	K 0 0 0 7 0 6 0 3 0 2	6 bolt 30 SW	1	○	
4-99	K 0 0 0 7 0 6 0 7 0 2	6 bolt 70 SW	1	○	
4-100					
4-101					
※4-102	L M 5 5 T B - 0 2 2 1 C 0	47-tooth axle gear	2		
※4-103	L M 5 5 T B - 0 2 1 9 C 0	46-tooth 15-tooth gear	2		
4-104					
4-105	K 0 0 0 3 0 6 0 6 0 2	6 bolt 60	1		

Catalog No.	Code No.	Part Name	Qty /Unit	Common Part	Retail Price
4-106	K 5 0 5 1 0 1 3 2 2 0	1C5191P washer 1322	8	○	
4-107	K 5 0 2 0 8 1 3 2 2 0	0.8NBS washer 1322	4	○	
4-108	K 5 0 1 0 3 4 0 4 6 2	0.3SPCC washer 4046.5	3	○	
4-109	K 5 0 0 0 1 4 0 0 0 2	14 washer	1		
4-110	K 0 2 1 0 1 4 0 0 0 1	14 disc spring L	1		
4-111	K 0 1 8 3 1 4 0 0 0 2	14 left-hand threaded nut P1.5	1		
4-112					
4-113	K 0 0 0 3 0 6 0 5 0 2	6 bolt 50	1		
4-114	K 5 0 0 0 0 6 0 0 0 2	6 washer	2		
4-115	K 0 2 0 0 0 6 0 0 0 2	6S washer	2		
4-116	K 2 9 2 9 0 0 0 0 0 0	Dynamax EP No. 1 grease	500g	○	
4-117	K 2 9 3 1 0 0 0 0 0 0	Excelite EP No. 2 grease	50g	○	
4-118	K 4 2 0 9 0 0 0 3 7 0	Lubrication 10 hour mark	2		
4-119	K 4 2 0 3 0 0 0 0 8 0	ON OFF mark	1	○	
4-120	K 4 0 1 0 2 1 7 2 5 0	2 oil seat 17.525	1	○	
4-121	K 5 0 1 0 3 4 0 4 6 2	0.3SPCC washer 4046.5	1	○	
4-122	K 4 0 3 9 0 0 0 0 7 0	Reel cover rubber A	2	○	

4. Frame/transmission-2

LM55GD • LM55GDF
LM65GD • LM65GDF LM65TD • LM65TDS

5. Handle/engine

LM55GD • LM55GDF
LM65GD • LM65GDF LM65TD • LM65TDS

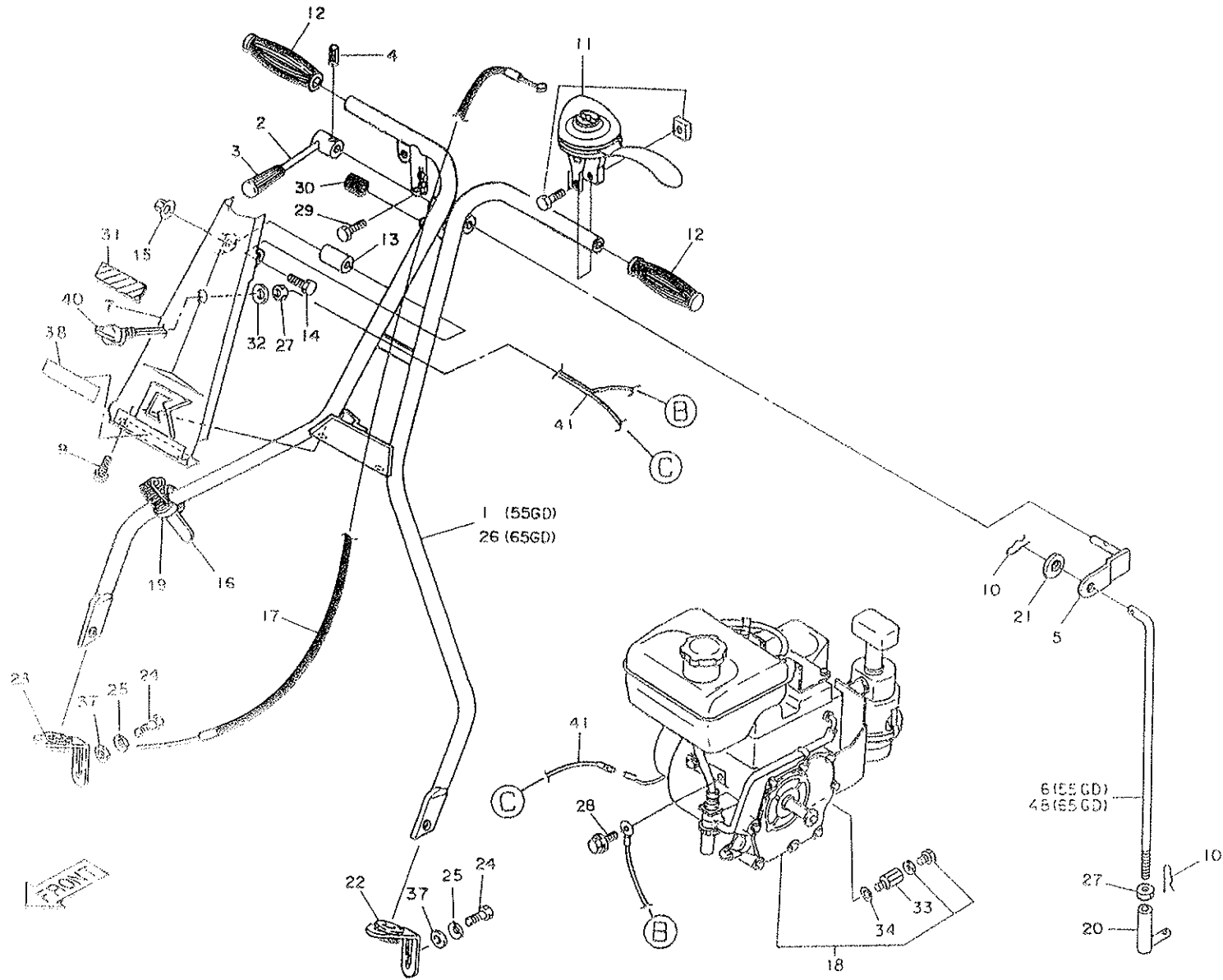

Catalog No.	Code No.	Part Name	Qty /Unit	Common Part	Retail Price
5-1	K 7 1 0 0 0 0 0 1 6 L	Handle 54	1		
5-2	K 8 0 6 0 0 0 0 0 1 0	Traveling clutch lever	1	○	
5-3	K 1 3 0 0 0 0 0 0 7 0	9 black grip 22	1	○	
5-4	K 0 3 2 0 0 5 0 2 0 1	5 spring pin 20	1	○	
5-5	K 7 3 2 1 0 0 0 0 3 3	Clutch lever shaft	1	○	
5-6	K 7 3 0 1 0 0 0 0 5 3	Clutch rod	1		
5-7	K 9 0 0 0 0 0 0 1 0 0	Handle cover COMP	1	○	
5-8					
5-9	K 0 0 4 8 0 4 0 1 0 2	4 + round head screw 10S	2	○	
5-10	K 0 3 4 0 8 0 0 0 0 2	8 locking snap pin	2	○	
5-11	K 1 2 0 3 5 2 1 0 0 0	Throttle lever E352100	1	○	
5-12	K 1 3 0 0 0 0 0 2 2 0	Black handle grip 20.5	2	○	
5-13	K 6 2 1 1 0 0 0 0 3 3	6.5SGP collar 10.516	1	○	
5-14	K 0 0 4 2 0 5 0 2 5 2	5 round head screw 25	1	○	
5-15	K 0 1 4 3 0 5 0 0 0 8	5 nut with disc spring	1	○	
5-16	K 4 1 4 1 0 0 0 0 1 0	Nylon band 140	3	○	
5-17	K 1 1 1 0 1 3 5 0 0 0	Throttle wire 1350	1		
5-18	K 2 6 2 0 0 0 0 1 8 0	Robin EY15D	1		
5-19	K 4 2 4 1 0 0 0 0 7 0	Urethane tube 7	1	○	
5-20	K 7 3 0 9 0 0 0 0 1 2	Rod adjuster	1	○	
5-21	K 5 0 0 0 0 8 0 0 0 2	8 washer	1		
5-22	LM55GB---0715E0	Left handle adjuster	1	○	
5-23	LM55GB---0716E0	Right handle adjuster	1	○	
5-24	K 0 0 1 0 1 0 0 2 5 1	10 heat treated bolt 25	2	○	
5-25	K 0 2 1 3 1 0 0 0 0 1	10 disc spring washer 1H	2	○	
5-26	K 7 1 0 0 0 0 0 1 3 L	Handle 64	1		
5-27	K 0 1 0 2 0 8 0 0 0 2	8 nut 3	2	○	
5-28	K 0 0 0 6 0 8 0 1 5 2	8 bolt 15S	1		
5-29	K 0 0 0 6 0 5 0 2 0 2	5 bolt 20S	1	○	
5-30	K 4 0 3 1 0 0 0 1 0 0	Stopper rubber	1	○	
5-31	K 4 0 3 3 0 0 0 0 7 0	Handle cover rubber cushion	1	○	
5-32	K 0 2 1 0 0 8 0 0 0 2	8 disc spring L	1	○	
5-33	K 0 0 7 1 0 0 0 9 0 2	Threaded pipe of waste oil	1	○	
5-34	Ⓔ021---11400---20	Gasket	1	○	
5-35					

○: Parts common to LM55GC

Catalog No.	Code No.	Part Name	Qty /Unit	Common Part	Retail Price
5-36					
5-37	K 5 0 1 2 3 1 0 2 5 3	2.3SPCC washer 1025	2	○	
5-38	K 4 2 0 1 0 0 0 1 2 0	Baroness mark 121	1		
5-39					
5-40	K 3 6 6 2 0 0 0 0 5 0	Engine switch FR56361-A	1		
5-41	K 3 6 2 0 0 0 0 5 5 0	Engine switch cord 8A	1		
5-42					
5-43					
5-44					
5-45					
5-46					
5-47					
5-48	K 7 3 0 1 0 0 0 0 6 3	Clutch rod	1		

5. Handle/engine

LM55GD • LM55GDF
LM65GD • LM65GDF LM65TD • LM65TDS

6. Brake parts

LM55GD • LM55GDF
LM65GD • LM65GDF LM65TD • LM65TDS

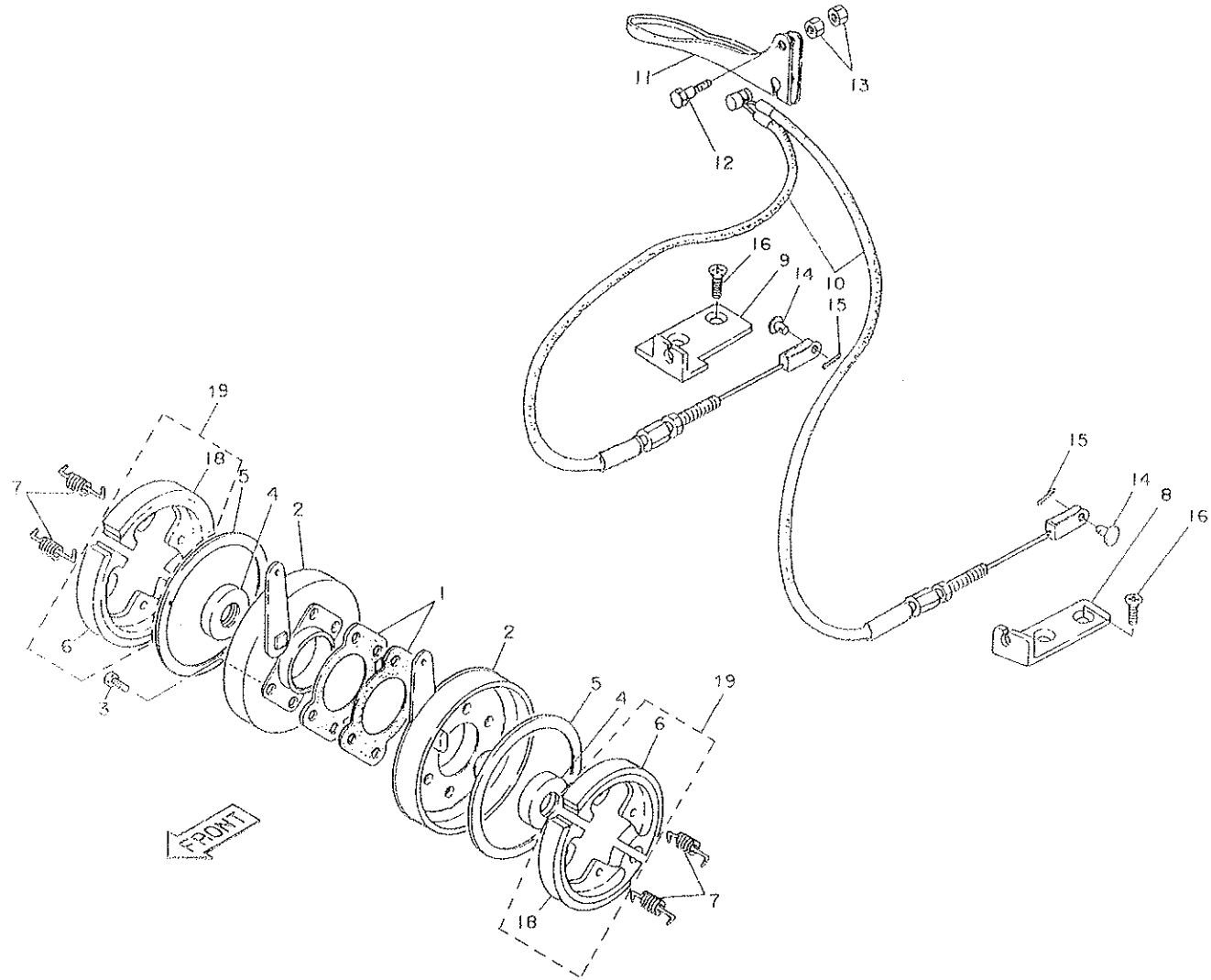

Catalog No.	Code No.	Part Name	Qty /Unit	Common Part	Retail Price
6-1	LM55GB--110120	Packing	2	○	
6-2	LM55GB--110223	Brake mounting plate	2	○	
6-3	K0006060202	6 bolt 20 S	8	○	
6-4	K0852042080	Oil seal P.JN20428	2	○	
6-5	K4009000010	1 felt 96110	2	○	
6-6	K1725000010	Brake shoe 100 right	2	○	
6-7	K1040000010	1.6 hook spring 845	4	○	
6-8	LM55GB--1113A3	Left brake wire mounting bracket	1	○	
6-9	LM55GB--111273	Right brake wire mounting bracket	1	○	
6-10	K1120140000	Brake wire 1400W	1	○	
6-11	K1241132014	Brake lever E113201	1	○	
6-12	K0071000213	Brake boll	1	○	
6-13	K0100060002	6 nut	2	○	
6-14	K6030050122	5 flat head pin 12	2	○	
6-15	K0300020162	2 cotter pin 16	2	○	
6-16	K0040060152	6 countersunk round head screw 15	4	○	
6-17					
6-18	K1725000020	Brake shoe 100 left	2	○	
6-19	K1725000040	Brake shoe 100 ass'y	2	○	
		Note: Use sets 6-6 and 6-18 when replacing the brake shoe.			

○: Parts common to LM55GC

Catalog No.	Code No.	Part Name	Qty /Unit	Common Part	Retail Price

6. Brake parts

LM55GD • LM55GDF
LM65GD • LM65GDF LM65TD • LM65TDS

7. Grass catcher/tools

LM55GD • LM55GDF
LM65GD • LM65GDF LM65TD • LM65TDS

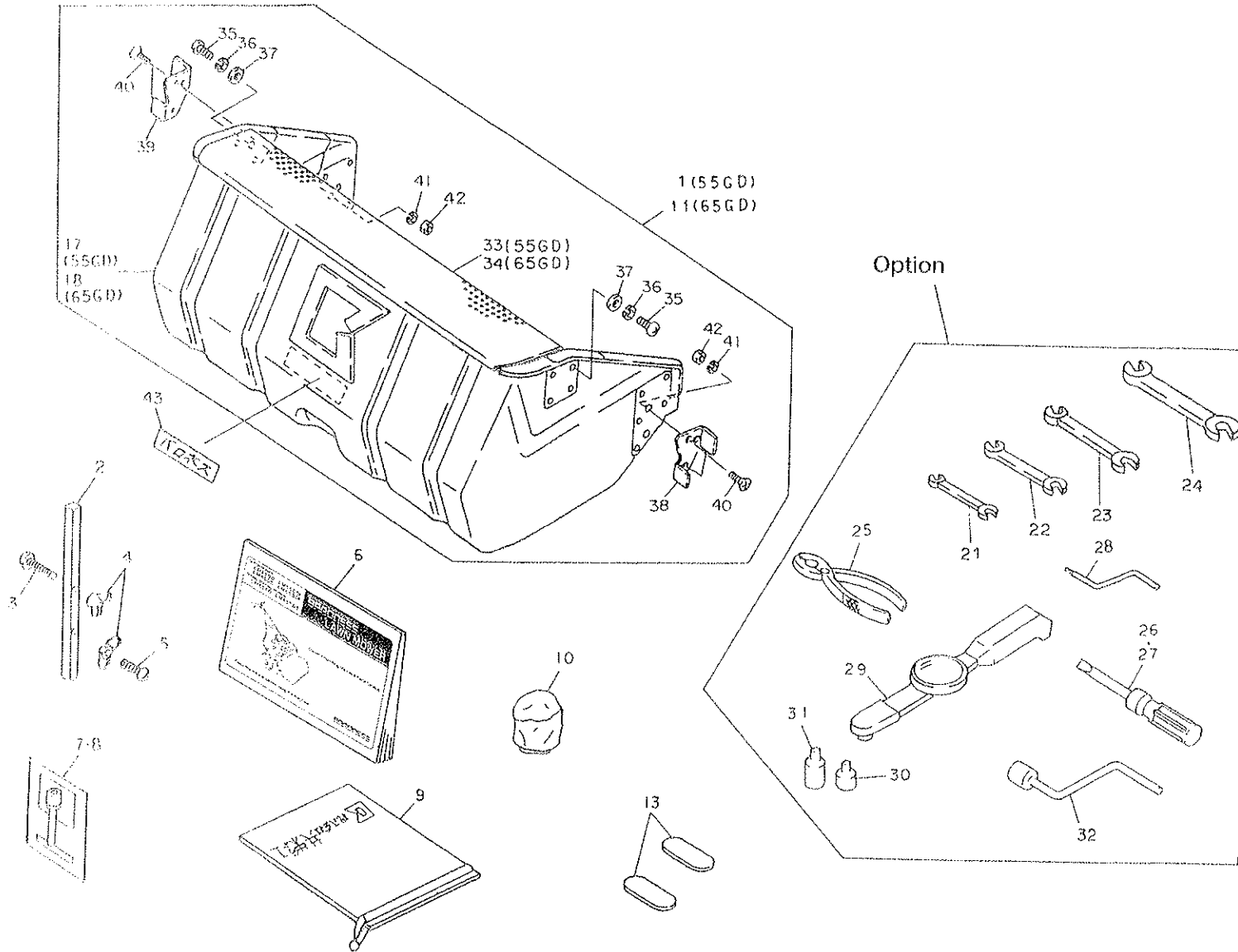

Catalog No.	Code No.	Part Name	Qty /Unit	Common Part	Retail Price
7-1	LM55GB-0800	Grass catcher	1		
7-2	K6090000072	Mowing height gauge 3	1	○	
7-3	K0046060502	6 + tapping screw C-1 round head 50	1	○	
7-4	K0141060002	6 butterfly nut 3	2	○	
7-5	K0046060302	6 + tapping screw C-1 round head 30	1	○	
7-6	LM55GD-00JE00	LM55GD handling manual and parts catalog	1		
7-7	K2620EY15D-10	EY15D tool	1		
7-8	K2620EY15D-03	EY150D operation manual	1	○	
7-9	K4801000020	Tool bag	1	○	
7-10	K4110000060	Cleaner cover A	1	○	
7-11	LM65GB-0800	Grass catcher	1		
7-12					
7-13	K4802000120	0.5 thickness gauge	2	○	
7-14					
7-15					
7-16					
7-17	LM55GB-0801B0	Small grass catcher	1		
7-18	LM65GB-0801B0	Large grass catcher	1		
7-19	Option tool				
7-21	K4810080102	Spanner 8 x 10	1		
7-22	K4810130172	Spanner 13 x 17	2		
7-23	K4810190222	Spanner 19 x 22	1		
7-24	K4810240272	Spanner 24 x 27	1		
7-25	K4830000012	Pliers	1		
7-26	K4820000010	+/- screwdriver	1		
7-27	K4820000020	- screwdriver through 200	1		
7-28	K6125000052	Reel lapping handle	1		
7-29	K4802000370	Torque wrench 6-60	1		
7-30	K4802000354	socket adapter 6.35 x 9.5	1		
7-31	K4802000364	socket adapter 9.5 x 12.7	1		
7-32	K4802000392	Lapping handle	1		
7-33	LM55GB-0805C0	Cover	1		
7-34	K716300005D	Grass box cover 675	1		
7-35	K0042080202	8 + round head screw 20	2		

○: Parts common to LM55GC

Catalog No.	Code No.	Part Name	Qty /Unit	Common Part	Retail Price
7-36	K0200080002	8S washer	2		
7-37	K5000080002	8 washer	2		
7-38	K5276000013	Left latch	1		
7-39	K5276000023	Right latch	1		
7-40	K0041060202	6 + countersunk head screw 20	4		
7-41	K0200060002	6S washer	4		
7-42	K0100060002	6 nut	4		
7-43	K4200000040	Baroness name	1		

7. Grass catcher/tools Items 7-21 through 7-31 are optional tools (and are not included with the mower).

**LM55GD • LM55GDF
LM65GD • LM65GDF LM65TD • LM65TDS**

8. Sulky unit (Option)

LM55GD • LM55GDF
LM65GD • LM65GDF LM65TD • LM65TDS

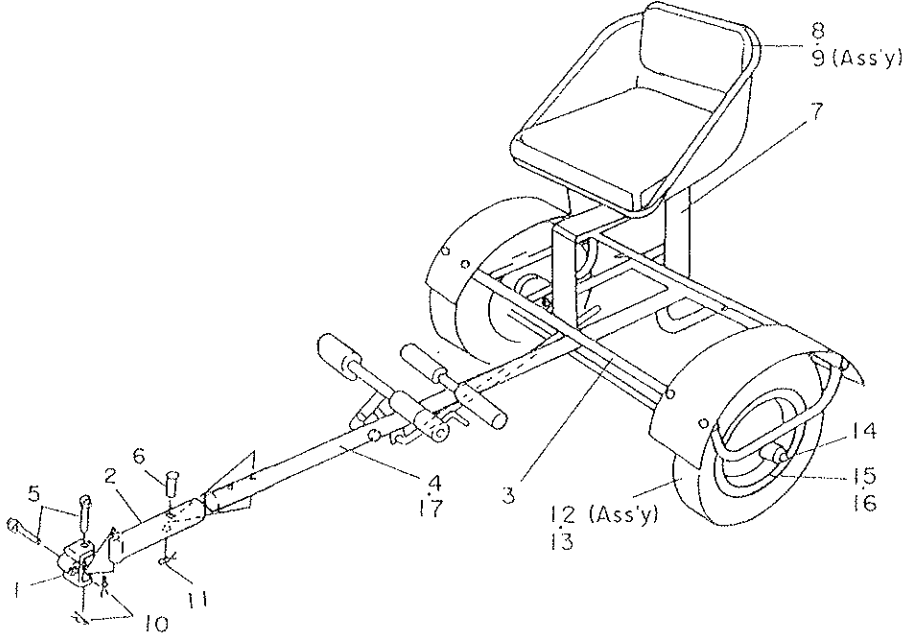

Catalog No.	Code No.	Part Name	Qty /Unit	Common Part	Retail Price
8-1	K 7 1 4 6 0 0 0 0 3 R	13 hitch bracket 44	1	○	
8-2	K 7 1 4 5 0 0 0 0 3 R	44 joint bracket 200	1	○	
8-3	L M 8 0 — S L 0 9 0 6 F R	Sulky cargo bed	1	○	
8-4	K 7 1 4 7 0 0 0 0 4 R	Sulky tow bar 940	1	○	
8-5	K 7 1 4 7 0 0 0 0 3 2	12.7 hitch pin 95	2	○	
8-6	K 0 3 3 1 0 0 0 0 0 2	10 snap pin	1	○	
8-7	L M 8 0 — S L 0 9 2 4 A R	Saddle mounting plate	1	○	
8-8	K 1 7 0 1 0 0 0 0 1 0	Saddle GTM	1	○	
8-9	K 1 7 0 0 0 0 0 0 4 0	Saddle GTM base ass'y	1	○	
8-10	K 0 3 3 1 3 0 0 0 0 2	13 snap pin	2	○	
8-11	K 0 3 3 1 0 0 0 0 0 2	10 snap pin	1	○	
8-12	K 2 0 3 0 0 0 0 0 5 0	Tire and wheel 3.00-8 ass'y	2	○	
8-13	K 2 0 3 1 0 0 0 0 4 0	Tire 3.00-8 2PR	2	○	
8-14	K 2 0 9 1 0 0 0 1 4 0	Tube 3.00-8	2	○	
8-15	K 2 0 9 0 0 0 0 0 8 R	Wheel 3.00-8 with valve hole	2	○	
8-16	K 2 0 9 0 0 0 0 0 9 R	Wheel 3.00-8	2	○	
8-17	K 7 1 4 7 0 0 0 0 5 R	Sulky tow bar 700 (for export)	1	○	

○: Parts common to LM55GC

Catalog No.	Code No.	Part Name	Qty /Unit	Common Part	Retail Price

8. Sulky unit (Option)

LM55GD • LM55GDF
LM65GD • LM65GDF LM65TD • LM65TDS

9. Groomer

LM55GD • LM55GDF
LM65GD • LM65GDF LM65TD • LM65TDS

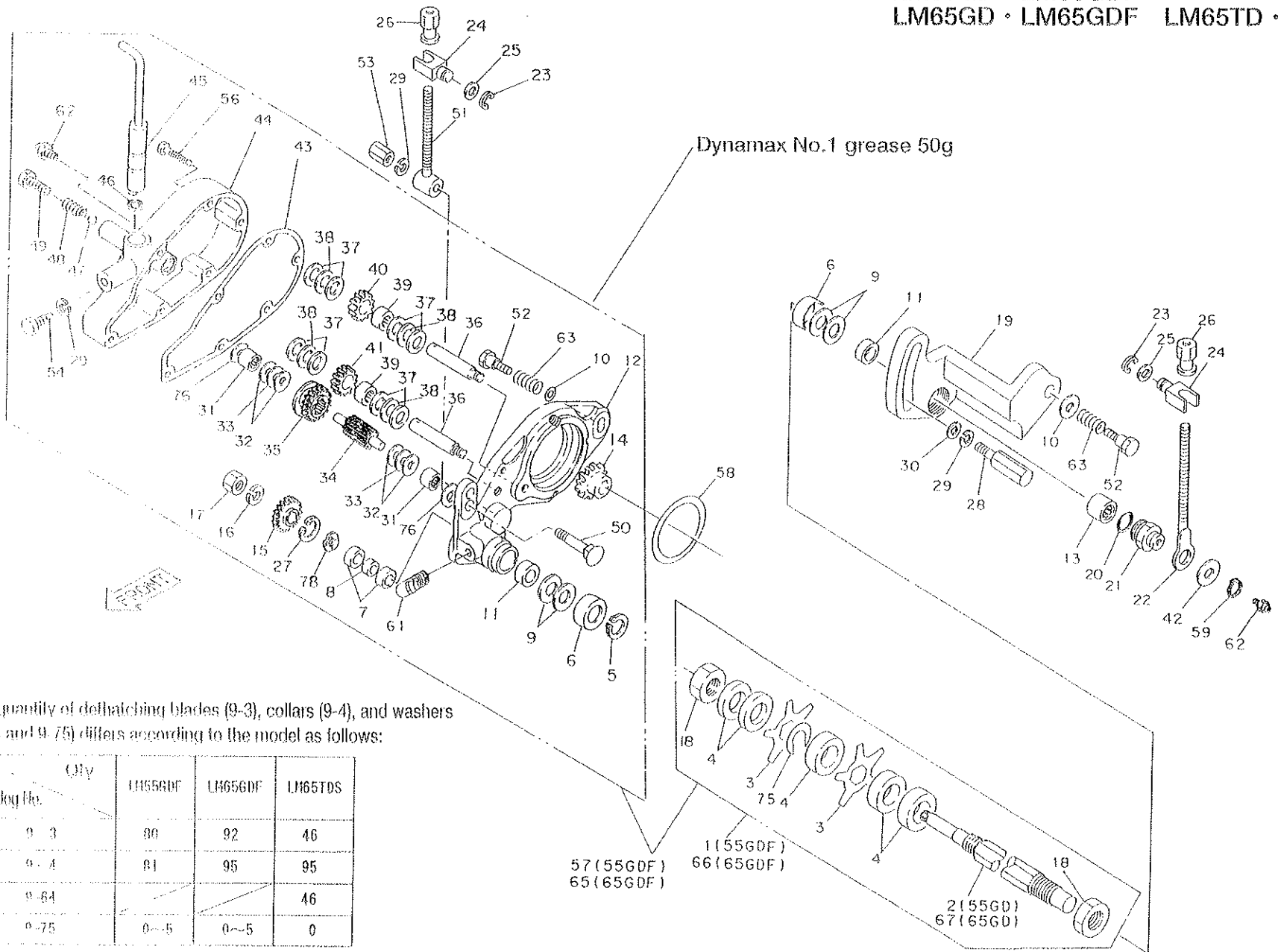

The quantity of deatching blades (9-3), collars (9-4), and washers (9-64 and 9-75) differs according to the model as follows:

Catalog No.	Qty	LM55GDF	LM65GDF	LM65TDS
9-3		80	92	46
9-4		81	95	95
9-64				46
9-75		0~5	0~5	0

Catalog No.	Code No.	Part Name	Qty /Unit	Common Part	Retail Price
9-1	LM55GCF1208A0	Vertical blades shaft ass'y	1		
9-2	LM55GCS1204A8	Vertical blades shaft (660)	1	○	
9-3	K2570000019	Detatching blade	※80	○	
9-4	LM55GBS1203B0	Collar	81	○	
9-5	K0401015001	Stop ring S15	1	○	
9-6	K5300000293	Dust cover	2	○	
9-7	K0611069010	Bearing 6901RDC3	2	○	
9-8	K6212001590	12.1STKM collar 1714	1	○	
9-9	K5051015280	1C5191P washer 1528	4	○	
9-10	K5090000250	2C5191P washer 8.522	2	○	
9-11	K0821522070	Oil seal MISA15227	2	○	
9-12	LM55GCS1225BR	Vertical gear case	1	○	
9-13	K0721520000	Needle TA1520Z	1	○	
9-14	LM55GDF1205Z0	23-tooth incl gear with M16 left-hand screw	1		
9-15	K6180000130	15-tooth gear for locking	1	○	
9-16	K0200100002	10 S washer	1	○	
9-17	K0160000322	10 left-hand screw nut P1	1	○	
9-18	K0160000302	17 special nut P1	2	○	
9-19	LM55TBS1207BR	Left vertical housing	1	○	
9-20	K0880018000	O-ring P18	1	○	
9-21	LM55GBS1231A0	Screw	1	○	
9-22	LM55TBS1229A3	Adjusting screw	1	○	
9-23	K0400010002	Stop ring E10	2		
9-24	K6090000502	Adjusting receiver	2		
9-25	K5011013222	1SPCC washer 1322	2		
9-26	K6084000063	Roller adjuster	2	○	
9-27	K0402024001	Stop ring R24	1	○	
9-28	K6081000062	Bolt 45	1	○	
9-29	K0200080002	8S washer	4	○	
9-30	K5000080002	8 washer	1	○	
9-31	K0720810000	Needle TA810Z	2	○	
9-32	K5051008180	1C5191P washer 818	4	○	
9-33	K5020808180	0.8NBS55 washer 818	2	○	
9-34	K6100000080	Vertical blades 2-shaft	1	○	
9-35	K6180000120	Clutch 18-tooth gear	1	○	

○: Parts common to LM55GC

Catalog No.	Code No.	Part Name	Qty /Unit	Common Part	Retail Price
9-36	K6120000310	Intermediate shaft	2	○	
9-37	K5051010160	1C5191P washer 1016	8	○	
9-38	K5020810160	0.8NBS55 washer 1016	4	○	
9-39	K0701013100	Needle KT101310	2	○	
9-40	LM55GCS1213Z0	18-tooth gear A	1	○	
9-41	LM55GCS1214Z0	18-tooth gear B	1		
9-42	K5051013220	1C5191P washer 1322	1	○	
9-43	LM55TBS1224Z0	Packing	1	○	
9-44	LM55GCS1237Z0	Gear case cover	1	○	
9-45	K7899000669	Lever	1	○	
9-46	K0880011000	O-ring P11	1	○	
9-47	K1500635000	6.35 steel ball	1	○	
9-48	K1000000090	1 compression spring 618	1	○	
9-49	K0007080152	8 bolt 15SW	1	○	
9-50	K0025080552	8 square-based round-head bolt 55	1	○	
9-51	LM55GBS1220B3	Vertical adjusting bolt	1	○	
9-52	LM55GBS1230C3	Right case locking bolt	2	○	
9-53	K0149083202	8 tall nut 20	1	○	
9-54	K0071000953	Stop bolt	1	○	
9-55	LM55GCF1304A0	55 brush shaft ass'y	1	○	
9-56	K0007060402	6 bolt 40 SW	6	○	
9-57	K8001000090	55GDF vertical gear case with blades	1	○	
9-58	K0882045000	O-ring G45	1	○	
9-59	K0401013001	Stop ring S13	1	○	
9-60				○	
9-61	K1440000022	C-shaped grease nipple	1	○	
9-62	K1440000012	Grease nipple	4	○	
9-63	K1000000309	1.6 compression spring 13.720	2	○	
9-64	K5090000653	0.5SPCC washer 19.732	39	○	
9-65	K8001000100	65GCD vertical gear case with blades	1	○	
9-66	LM65GCF1208Z0	Vertical blades shaft ass'y	1	○	
9-67	LM65GCS1204A8	Vertical blades shaft (750)	1	○	
9-68					
9-69	LM65GCF1304A0	65 brush shaft ass'y	1	○	
9-70					

9. Groomer

LM55GD • LM55GDF
LM65GD • LM65GDF LM65TD • LM65TDS

9. Groomer

LM55GD • LM55GDF
LM65GD • LM65GDF LM65TD • LM65TDS

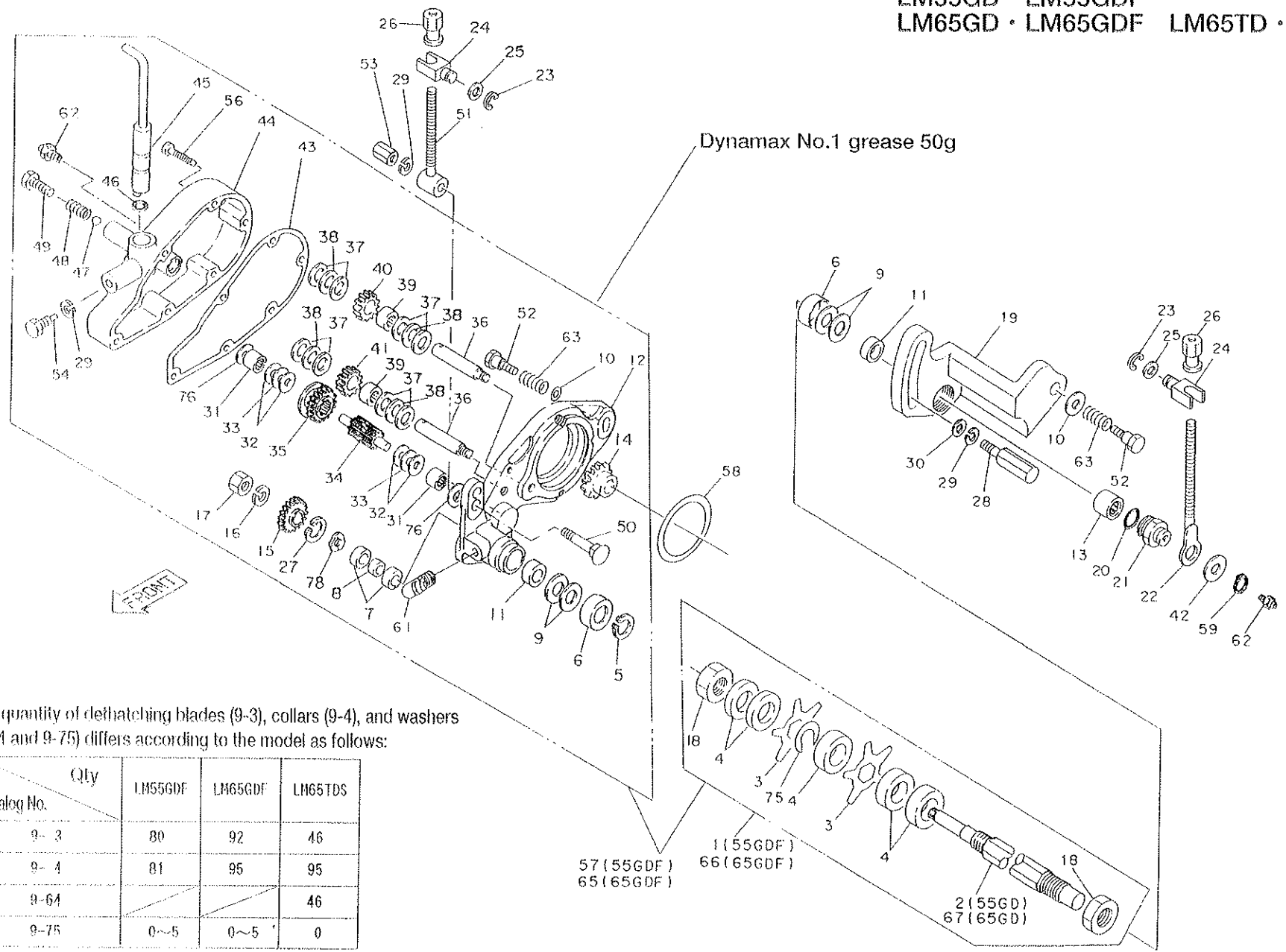

The quantity of detaching blades (9-3), collars (9-4), and washers (9-64 and 9-75) differs according to the model as follows:

Catalog No.	Qty	LM55GDF	LM65GDF	LM65TDS
9-3		80	92	46
9-4		81	95	95
9-64				46
9-75		0~5	0~5	0

57 (55GDF)
65 (65GDF)

1 (55GDF)
66 (65GDF)

2 (55GD)
67 (65GD)

Catalog No.	Code No.	Part Name	Qty /Unit	Common Part	Retail Price
9-71					
9-72					
9-73	LM65TCS1208Z0	Vertical blades shaft ass'y	1	<input type="radio"/>	
9-74	K8001000080	65TCS vertical gear case with blades	1	<input type="radio"/>	
9-75	K5090000673	0.5SPCC adjusting washer	0~5	<input type="radio"/>	
9-76	K5090000000	1.6SK3 washer 215	2	<input type="radio"/>	
9-77	LM55GCF1301Z3	Brush shaft	1	<input type="radio"/>	
9-78	K0220160110	16011 corrugated washer	1		

○: Parts common to LM55GC

Catalog No.	Code No.	Part Name	Qty /Unit	Common Part	Retail Price

9. Tee Groomer

LM55GD • LM55GDF
LM65GD • LM65GDF LM65TD • LM65TDS

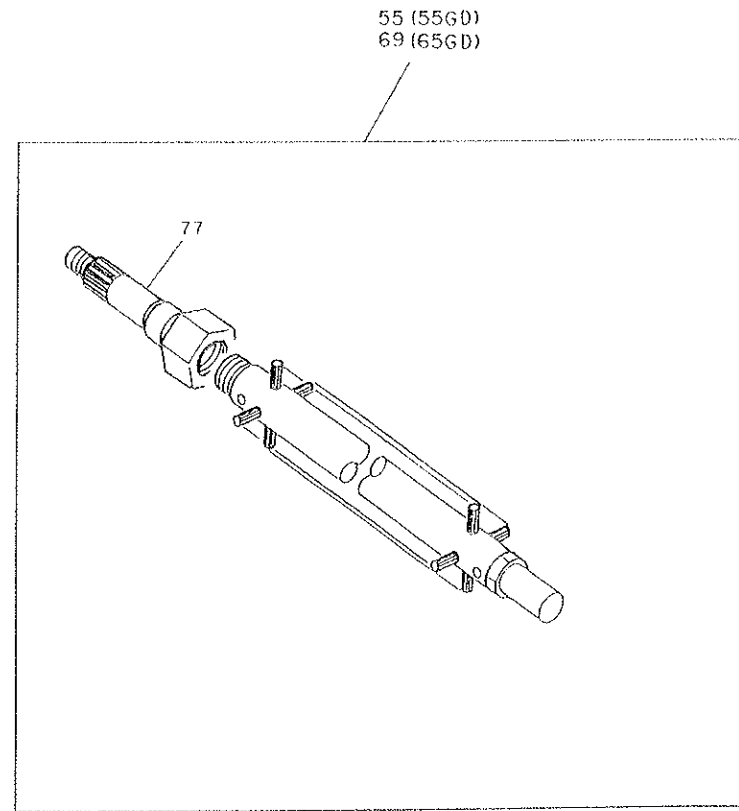
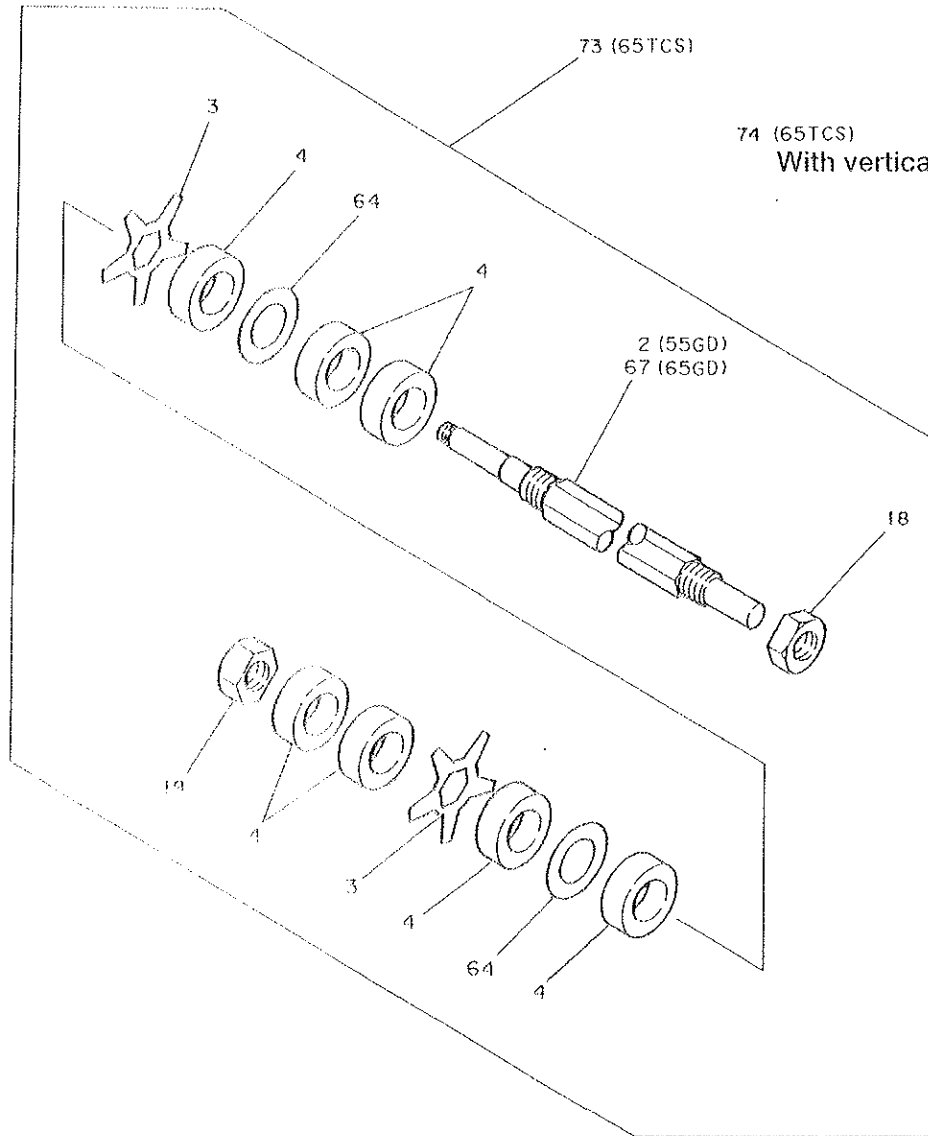

Catalog No.	Code No.	Part Name	Qty /Unit	Common Part	Retail Price
9-1	LM55GCF1208A0	Vertical blades shaft ass'y	1		
9-2	LM55GCS1204A8	Vertical blades shaft (660)	1	○	
9-3	K2570000019	Detaching blade	※80	○	
9-4	LM55GBS1203B0	Collar	81	○	
9-5	K0401015001	Stop ring S15	1	○	
9-6	K5300000293	Dust cover	2	○	
9-7	K0611069910	Bearing 6901RDC3	2	○	
9-8	K6212001590	12.1STKM collar 1714	1	○	
9-9	K5051015280	1C5191P washer 1528	4	○	
9-10	K5090000250	2C5191P washer 8.522	2	○	
9-11	K0821522070	Oil seal MHSA15227	2	○	
9-12	LM55GCS1225B11	Vertical gear case	1	○	
9-13	K0721520000	Needle TA1520Z	1	○	
9-14	LM55GDF1206A0	23-tooth reel gear with M16 left-hand screw	1		
9-15	K6180000130	15-tooth gear for locking	1	○	
9-16	K0200100002	10 S washer	1	○	
9-17	K0160000322	10 left-hand screw nut P1	1	○	
9-18	K0160000302	17 special nut P1	2	○	
9-19	LM55TBS1207E11	Left vertical housing	1	○	
9-20	K0880018000	O-ring P18	1	○	
9-21	LM55GBS1231A0	Screw	1	○	
9-22	LM55TBS1229A3	Adjusting screw	1	○	
9-23	K0400010002	Stop ring E10	2		
9-24	K6090000502	Adjusting receiver	2		
9-25	K5011013222	1SPCC washer 1322	2		
9-26	K6084000063	Roller adjuster	2	○	
9-27	K0402024001	Stop ring R24	1	○	
9-28	K6081000062	Bolt 45	1	○	
9-29	K0200080002	8S washer	4	○	
9-30	K5000080002	8 washer	1	○	
9-31	K0720810000	Needle TA810Z	2	○	
9-32	K5051008180	1C5191P washer 818	4	○	
9-33	K5020808180	0.8NBS55 washer 818	2	○	
9-34	K6100000080	Vertical blades 2-shaft	1	○	
9-35	K6180000120	Clutch 18-tooth gear	1	○	

○: Parts common to LM55GC

Catalog No.	Code No.	Part Name	Qty /Unit	Common Part	Retail Price
9-36	K6120000310	Intermediate shaft	2	○	
9-37	K5051010160	1C5191P washer 1016	8	○	
9-38	K5020810160	0.8NBS55 washer 1016	4	○	
9-39	K0701013100	Needle KT101310	2	○	
9-40	LM55GCS1213Z0	18-tooth gear A	1	○	
9-41	LM55GCS1214Z0	18-tooth gear B	1		
9-42	K5051013220	1C5191P washer 1322	1	○	
9-43	LM55TBS1224Z0	Packing	1	○	
9-44	LM55GCS1237Z0	Gear case cover	1	○	
9-45	K7899000669	Lever	1	○	
9-46	K0880011000	O-ring P11	1	○	
9-47	K1500635000	6.35 steel ball	1	○	
9-48	K1000000090	1 compression spring 618	1	○	
9-49	K0007080152	8 bolt 15SW	1	○	
9-50	K0025080552	8 square-based round-head bolt 55	1	○	
9-51	LM55GBS1220B3	Vertical adjusting bolt	1	○	
9-52	LM55GBS1230C3	Right case locking bolt	2	○	
9-53	K0149083202	8 tall nut 20	1	○	
9-54	K0071000953	Stop bolt	1	○	
9-55	LM55GCF1304A0	55 brush shaft ass'y	1	○	
9-56	K0007060402	6 bolt 40 SW	6	○	
9-57	K8001000090	55GDF vertical gear case with blades	1	○	
9-58	K0882045000	O-ring G45	1	○	
9-59	K0401013001	Stop ring S13	1	○	
9-60				○	
9-61	K1440000022	C-shaped grease nipple	1	○	
9-62	K1440000012	Grease nipple	4	○	
9-63	K1000000309	1.6 compression spring 13.720	2	○	
9-64	K5090000653	0.5SPCC washer 19.732	39	○	
9-65	K8001000100	65GCD vertical gear case with blades	1	○	
9-66	LM65GCF1208Z0	Vertical blades shaft ass'y	1	○	
9-67	LM65GCS1204A8	Vertical blades shaft (750)	1	○	
9-68					
9-69	LM65GCF1304A0	65 brush shaft ass'y	1	○	
9-70					

9. Tee Groomer

LM55GD • LM55GDF
LM65GD • LM65GDF LM65TD • LM65TDS

9. Tee Groomer

LM55GD • LM55GDF
LM65GD • LM65GDF LM65TD • LM65TDS

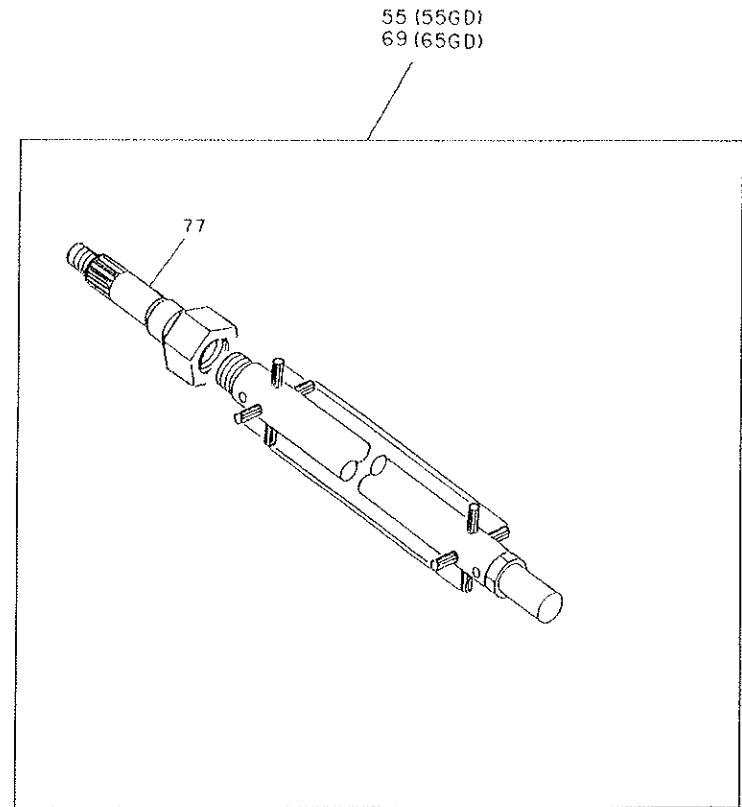
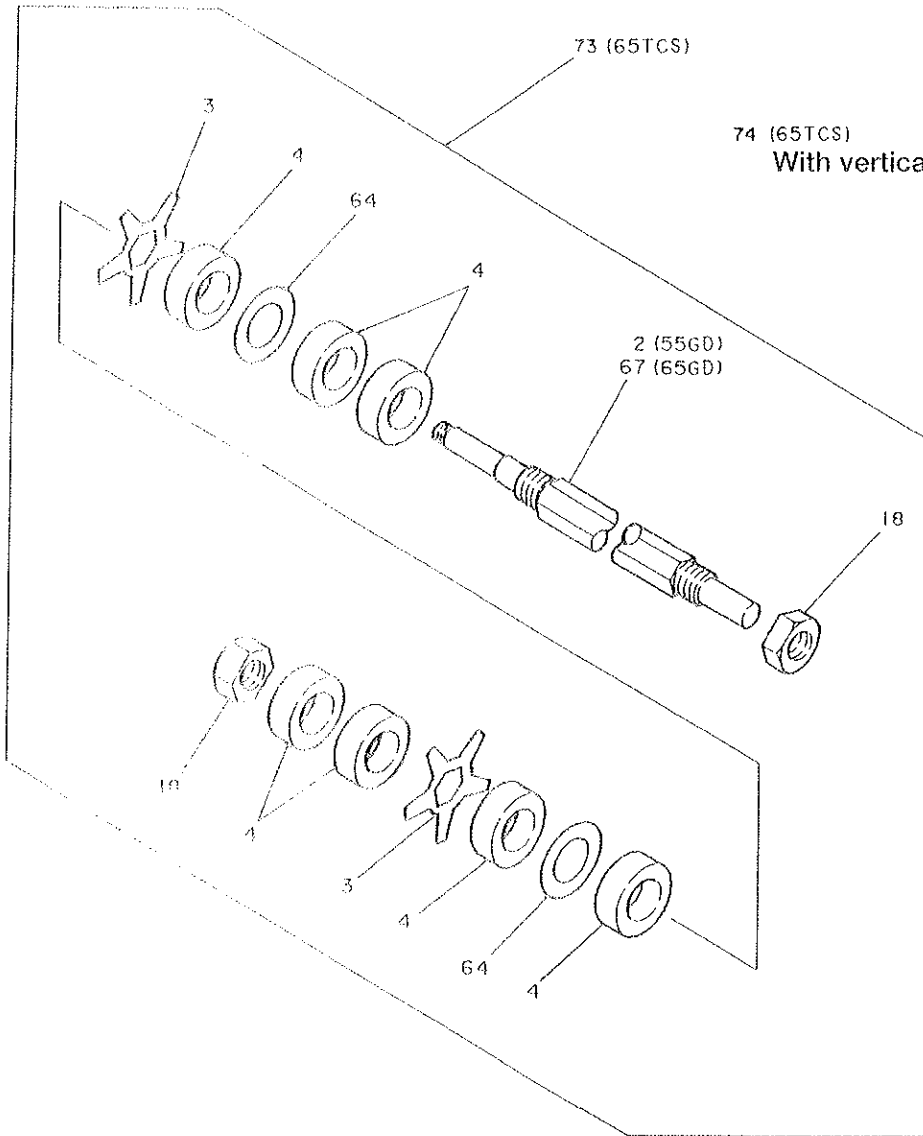

Catalog No.	Code No.	Part Name	Qty /Unit	Common Part	Retail Price
9-71					
9-72					
9-73	LM65TCS1208Z0	Vertical blades shaft ass'y	1	○	
9-74	K8001000080	65TCS vertical gear case with blades	1	○	
9-75	K5090000673	0.5SPCC adjusting washer	0~5	○	
9-76	K509000090	1.6SK3 washer 215	2	○	
9-77	LM55GCF1301Z3	Brush shaft	1	○	
9-78	K0220160110	16011 corrugated washer	1		

○: Parts common to LM55GC

Catalog No.	Code No.	Part Name	Qty /Unit	Common Part	Retail Price

9. Tee Groomer

LM55GD • LM55GDF
LM65GD • LM65GDF LM65TD • LM65TDS

10. Sweeping brush (Option)

LM55GD • LM55GDF
LM65GD • LM65GDF LM65TD • LM65TDS

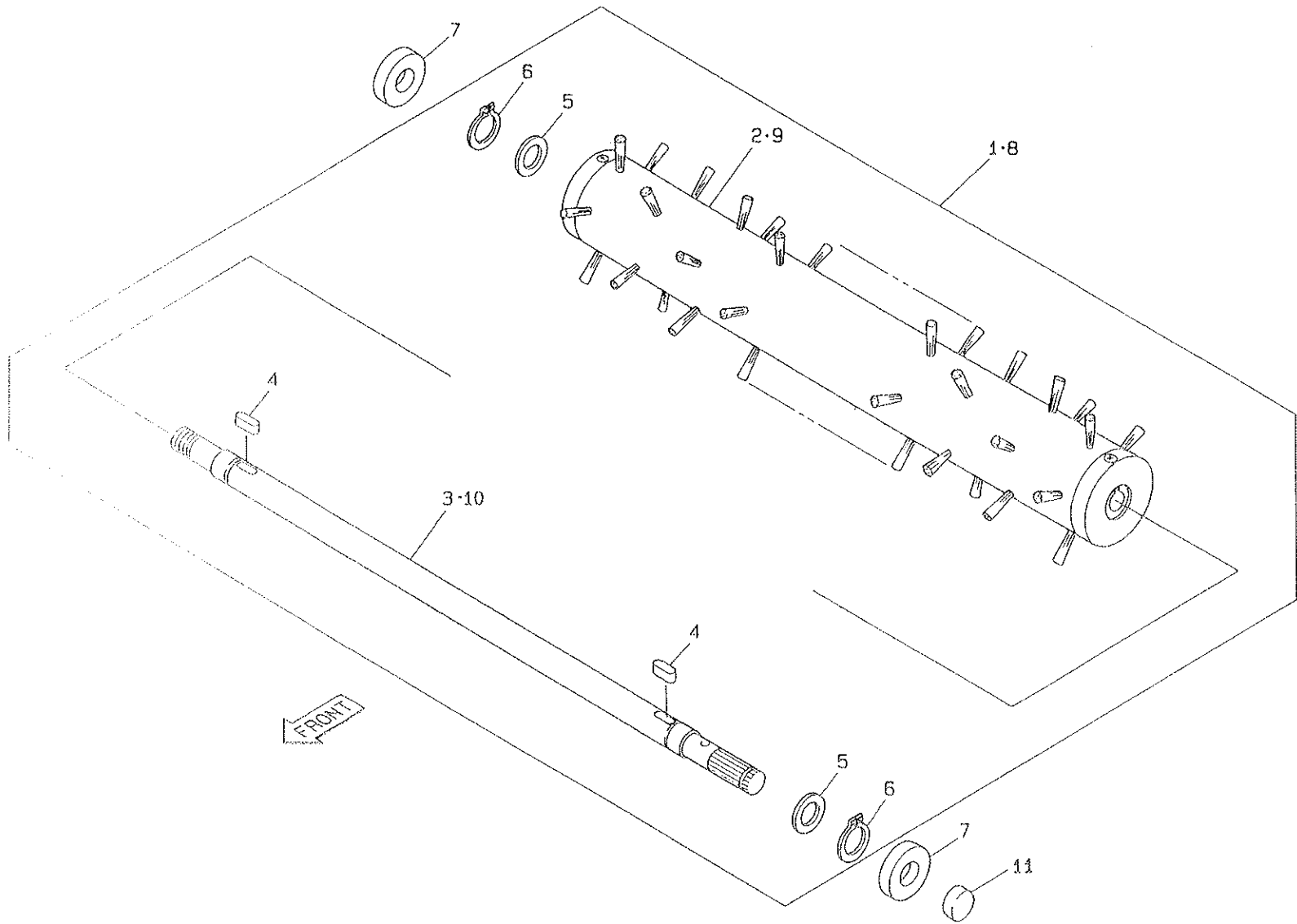

Catalog No.	Code No	Part Name	Qty /Unit	Common Part	Retail Price
10-1	LM55GD-150170	Brush shaft ass'y	1		
10-2	K4150000030	66 brush 135COMP	1	○	
10-3	LM55GD-150220	Brush shaft	1		
10-4	K0500505160	5 both-end round key 516	2	○	
10-5	K5051022300	105191P washer 2230	2	○	
10-6	K0401022001	Stop ring S22	2	○	
10-7	K0852242080	Oil seal P,IN22428	2	○	
10-8	LM65GD-150170	Brush shaft ass'y	1		
10-9	K4150000040	65 brush 135COMP	1	○	
10-10	LM65GD-150220	Brush shaft	1		
10-11	K0890000050	plug 28	1		

○: Parts common to LM55GC

Catalog No.	Code No.	Part Name	Qty /Unit	Common Part	Retail Price

10. Sweeping brush (Option)

LM55GD • LM55GDF
 LM65GD • LM65GDF LM65TD • LM65TDS

11. Vertical blades (Option)

LM55GD • LM55GDF
LM65GD • LM65GDF LM65TD • LM65TDS

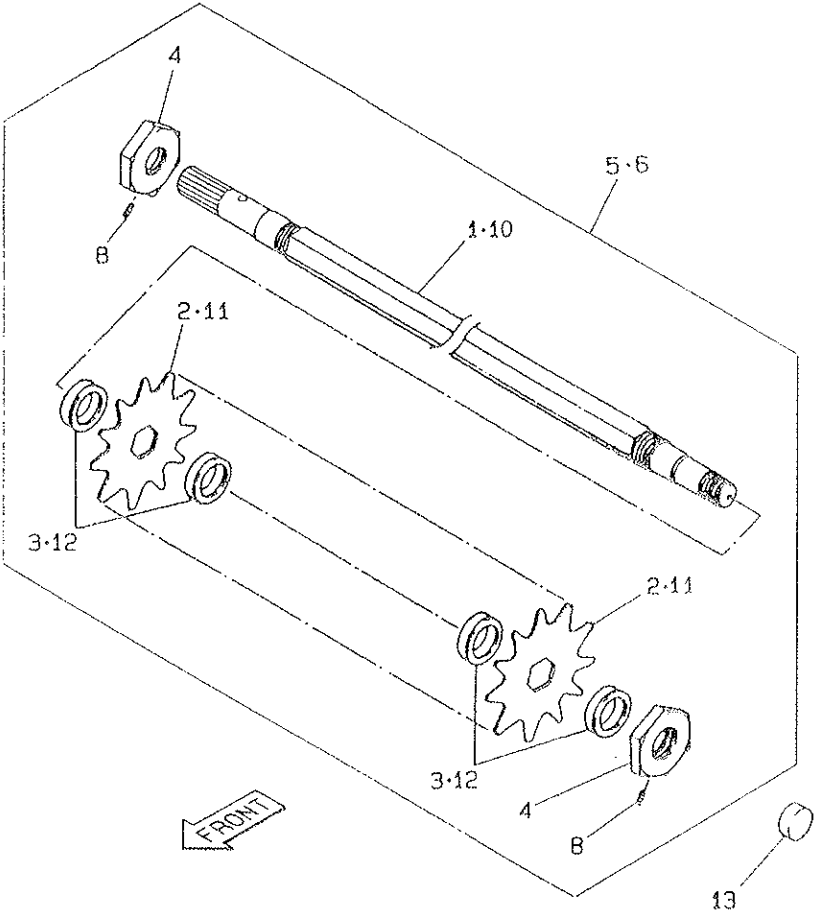

Catalog No.	Code No.	Part Name	Qty /Unit	Common Part	Retail Price
11-1	LM 5 5 GD - 1 6 0 2 Z 3	Vertical blades shaft 55	1		
11-2	K 2 5 7 0 0 0 0 0 2 9	Vertical blade 128	36	○	
11-3	K 6 2 1 2 0 0 1 1 7 3	31.7STKM collar 4213	37	○	
11-4	K 0 1 6 0 0 0 0 4 2 3	27 special nut P1.5-10	2	○	
11-5	LM 5 5 GD - 1 6 0 1 Z 0	Vertical blades ass'y			
11-6	LM 6 5 GD - 1 6 0 1 Z 0	Vertical blades ass'y			
11-7					
11-8	K 0 0 2 3 0 6 0 1 2 1	6 hollow set 12	2	○	
11-9					
11-10	LM 6 5 GD - 1 6 0 2 Z 3	Vertical blades shaft 65	1		
11-11	K 2 5 7 0 0 0 0 0 2 9	Vertical blade 128	43	○	
11-12	K 6 2 1 2 0 0 1 1 7 3	31.7STKM collar 4213	44	○	
11-13	K 0 8 9 0 0 0 0 0 5 0	Plug 28	1		

○: Parts common to LM55GC

Catalog No.	Code No.	Part Name	Qty /Unit	Common Part	Retail Price

11. Vertical blades (Option)

LM55GD • LM55GDF
LM65GD • LM65GDF LM65TD • LM65TDS



KYOISHA CO., LTD.

Head Office
1-26, Miyuki-cho, Toyokawa,
Aichi-Pref. 442-8530 Japan.

BRONNERS
Turf Care Machinery
Tel : (0533) 84-1221
Fax : (0533) 84-1220